

Image not found or type unknown



Ref. No.:

506-02031008

## **Overview and Technical Data:**

# **MECOF - Dynamill 3000 Portal Milling Machine**

**[MECOF](#)**

the 1990s, the number of people in the UK who are employed in the public sector has increased from 10.5 million to 12.5 million, and the number of people in the public sector who are employed in the health sector has increased from 2.5 million to 3.5 million (Department of Health 2000).

There are a number of reasons why the public sector has become an important employer in the UK. One of the main reasons is that the public sector has become an important provider of social services, such as health care, education, and social housing. The public sector has also become an important provider of infrastructure, such as roads, bridges, and public transport. The public sector has also become an important provider of social services, such as health care, education, and social housing.

There are a number of reasons why the public sector has become an important employer in the UK. One of the main reasons is that the public sector has become an important provider of social services, such as health care, education, and social housing. The public sector has also become an important provider of infrastructure, such as roads, bridges, and public transport. The public sector has also become an important provider of social services, such as health care, education, and social housing.

There are a number of reasons why the public sector has become an important employer in the UK. One of the main reasons is that the public sector has become an important provider of social services, such as health care, education, and social housing. The public sector has also become an important provider of infrastructure, such as roads, bridges, and public transport. The public sector has also become an important provider of social services, such as health care, education, and social housing.

There are a number of reasons why the public sector has become an important employer in the UK. One of the main reasons is that the public sector has become an important provider of social services, such as health care, education, and social housing. The public sector has also become an important provider of infrastructure, such as roads, bridges, and public transport. The public sector has also become an important provider of social services, such as health care, education, and social housing.

There are a number of reasons why the public sector has become an important employer in the UK. One of the main reasons is that the public sector has become an important provider of social services, such as health care, education, and social housing. The public sector has also become an important provider of infrastructure, such as roads, bridges, and public transport. The public sector has also become an important provider of social services, such as health care, education, and social housing.

There are a number of reasons why the public sector has become an important employer in the UK. One of the main reasons is that the public sector has become an important provider of social services, such as health care, education, and social housing. The public sector has also become an important provider of infrastructure, such as roads, bridges, and public transport. The public sector has also become an important provider of social services, such as health care, education, and social housing.

There are a number of reasons why the public sector has become an important employer in the UK. One of the main reasons is that the public sector has become an important provider of social services, such as health care, education, and social housing. The public sector has also become an important provider of infrastructure, such as roads, bridges, and public transport. The public sector has also become an important provider of social services, such as health care, education, and social housing.

Year of Build:  
Jan 2000

## **Description:**

# **MECOF Dynamill 3000 - Portal Milling Machine 5 Axis**

- Control Fidia CNC M 20
- Axis: 3+2
- Travels X / Y / Z 5,500 x 3,000 x 1,500 mm
- Table 5000 x 3000 mm
- Tisch load about 15 t
- Spindle 24,000 rev / min 17,5 KW
- Rapid Feed 15000 mm/min
- Head unit:
  - GRP-electric spindle
  - Universal Head
- HSK 63a
- Toolchanger 24x
- IKZ

Machine can be visited under power.

## **Technical Data:**

### **Technical Data:**

Control:

[FIDIA](#)

Spindle Speed:

24.000 rpm

Tool Capacity:

24 x

### **Travels:**

X-Axis:

5.500 mm

Y-Axis:

3.000mm

Z-Axis:

1.500 mm

### **Dimensions and Weight:**

Weight:

30.000 kg

### **Buyer Information:**

Condition:

[Very good condition](#)

Availability:

[Sold](#)

Sold as:

[EXW \(Ex Works - Incoterm\)](#)

VAT:

[19 %](#)

Buyers Premium:

[15 %](#)

Location:

Germany

**Images:**



1





3



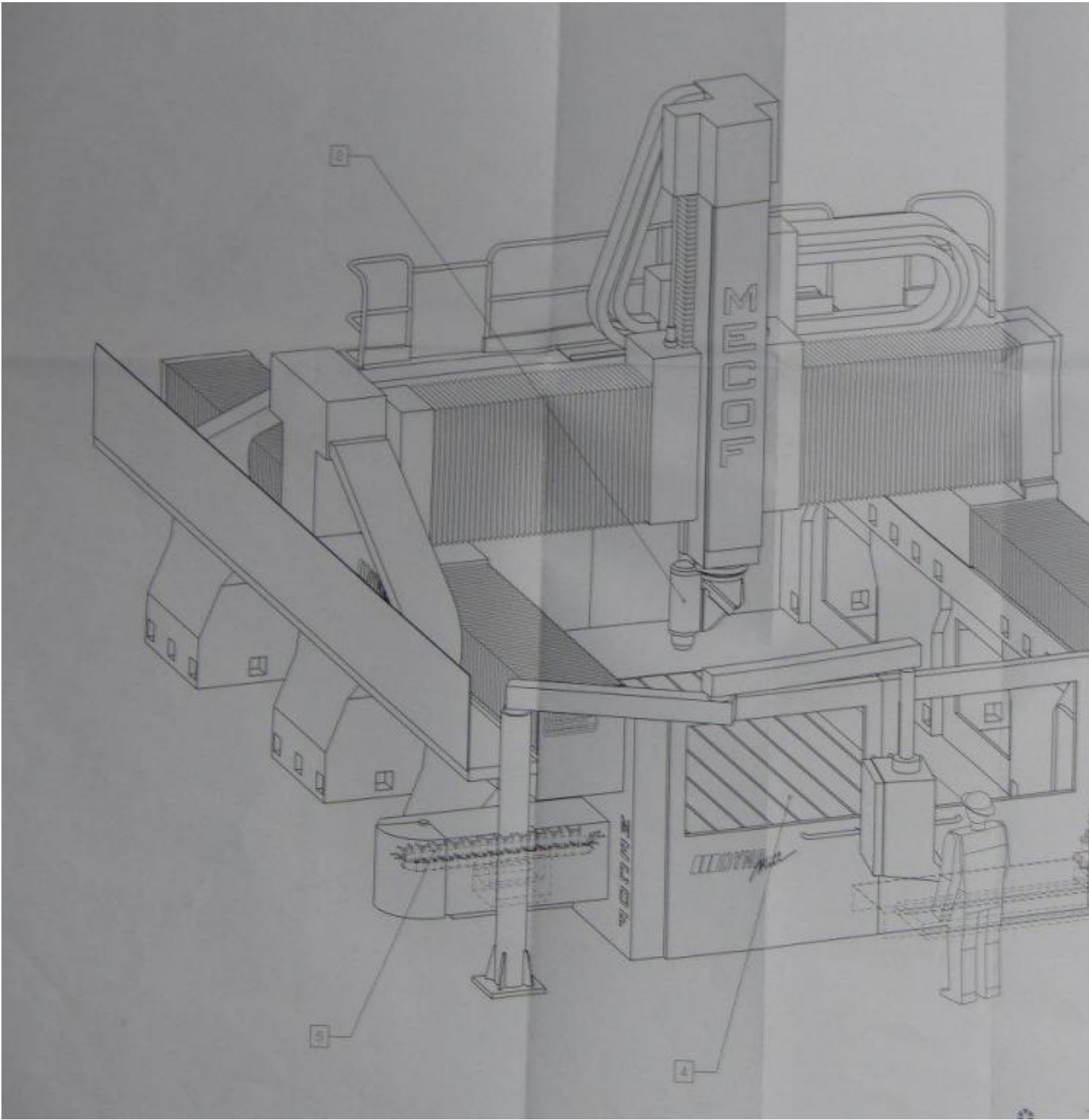

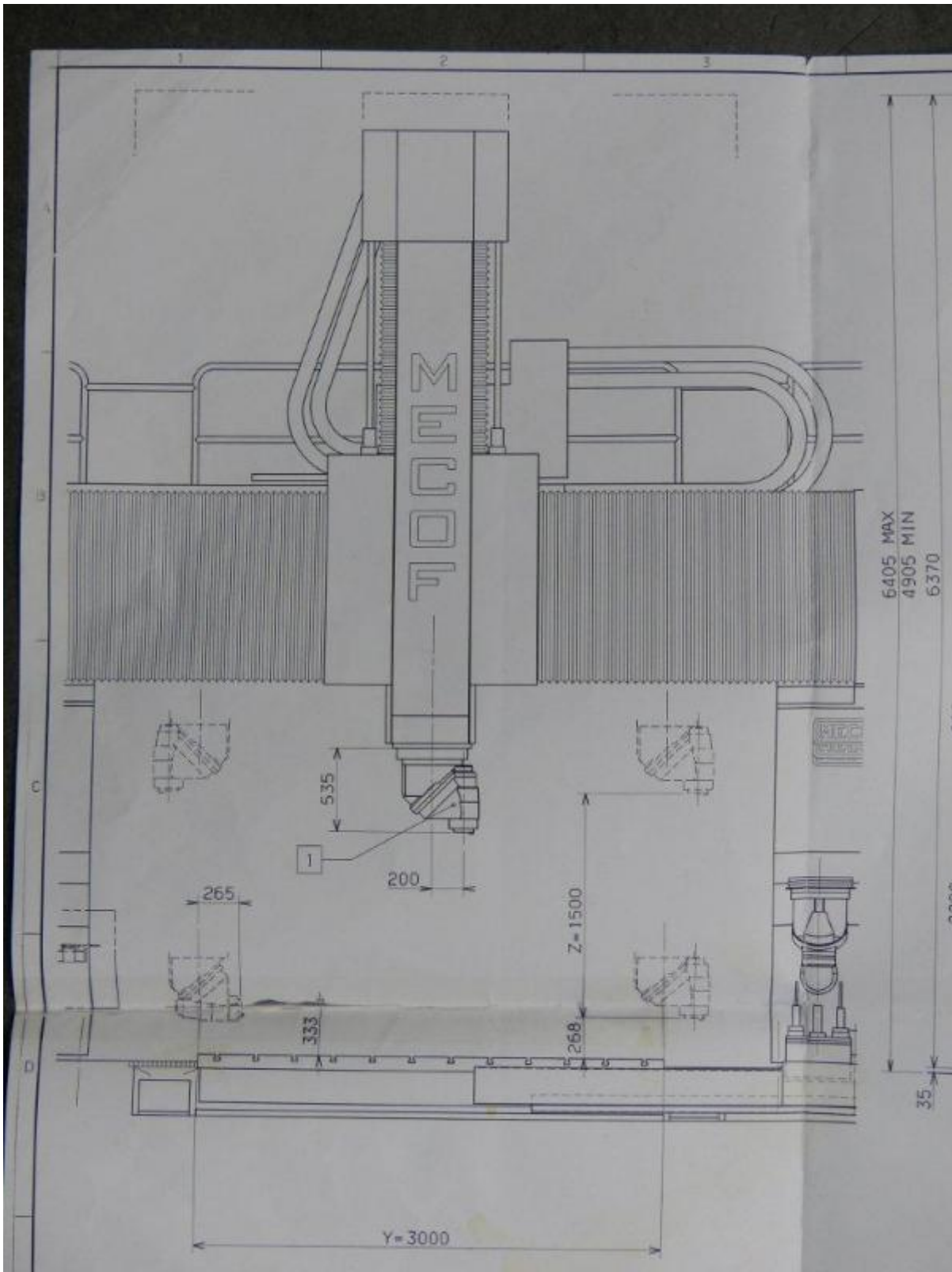

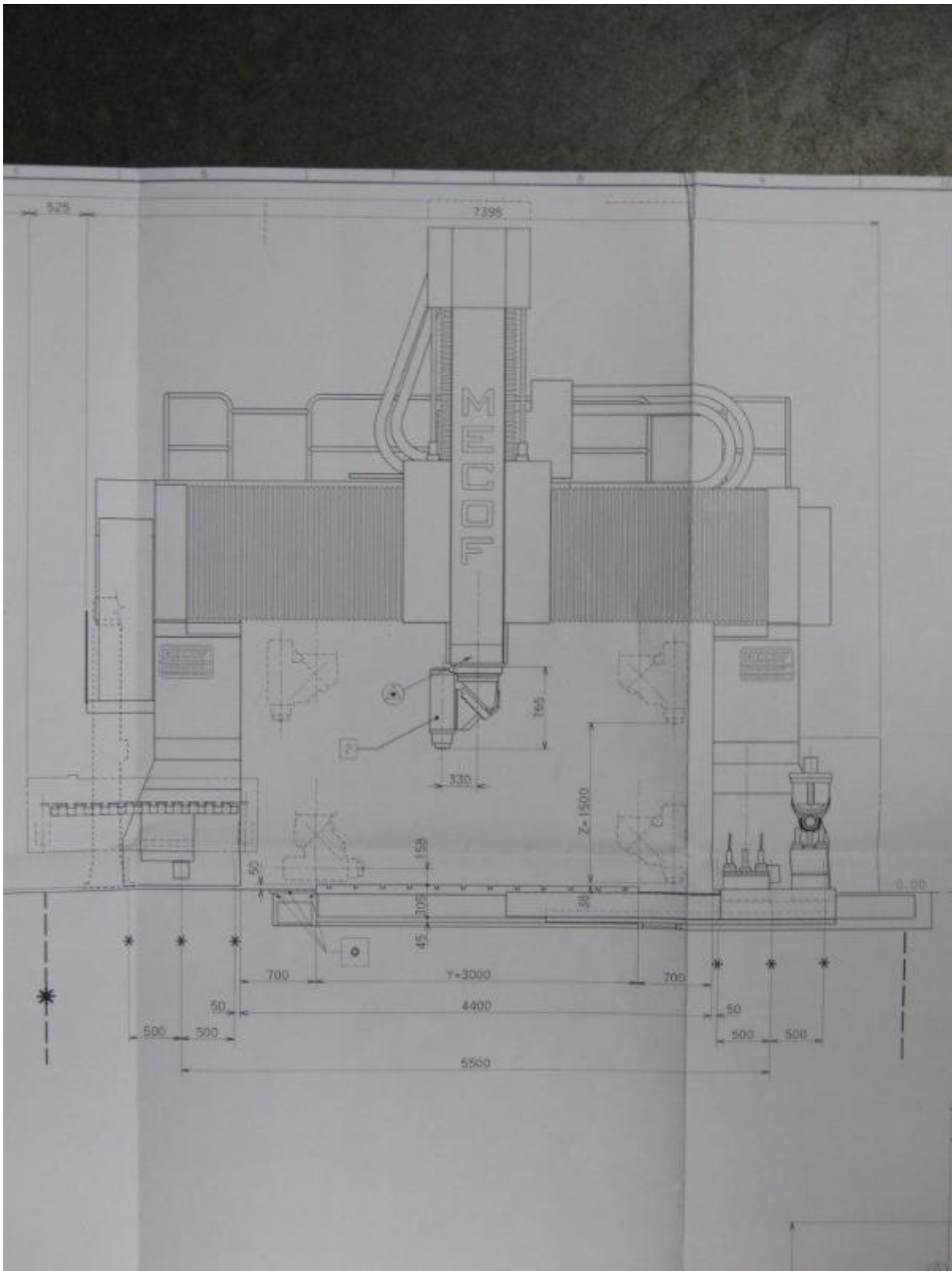



KLIMAGERÄTE "SEIFERT"

HYDRAULIK-ANLAGE

800

135



Cartella  
B66

MACCHINA

**2DYN**  
3000/L

*Mill*

Modello N. 2DYN/0251

GRUPPO AUSSENANSICHT

AGGIORN

Scala /

Sost

Scala 1:25

DENOM. PLATZBEDARFSPLAN

Comm

Disegnato da Lastricina

DISEG

Approvato da /

NOTE X=5500; Y=3000; Z=1500

DI LEG

21/12/1999

A TER

15

16

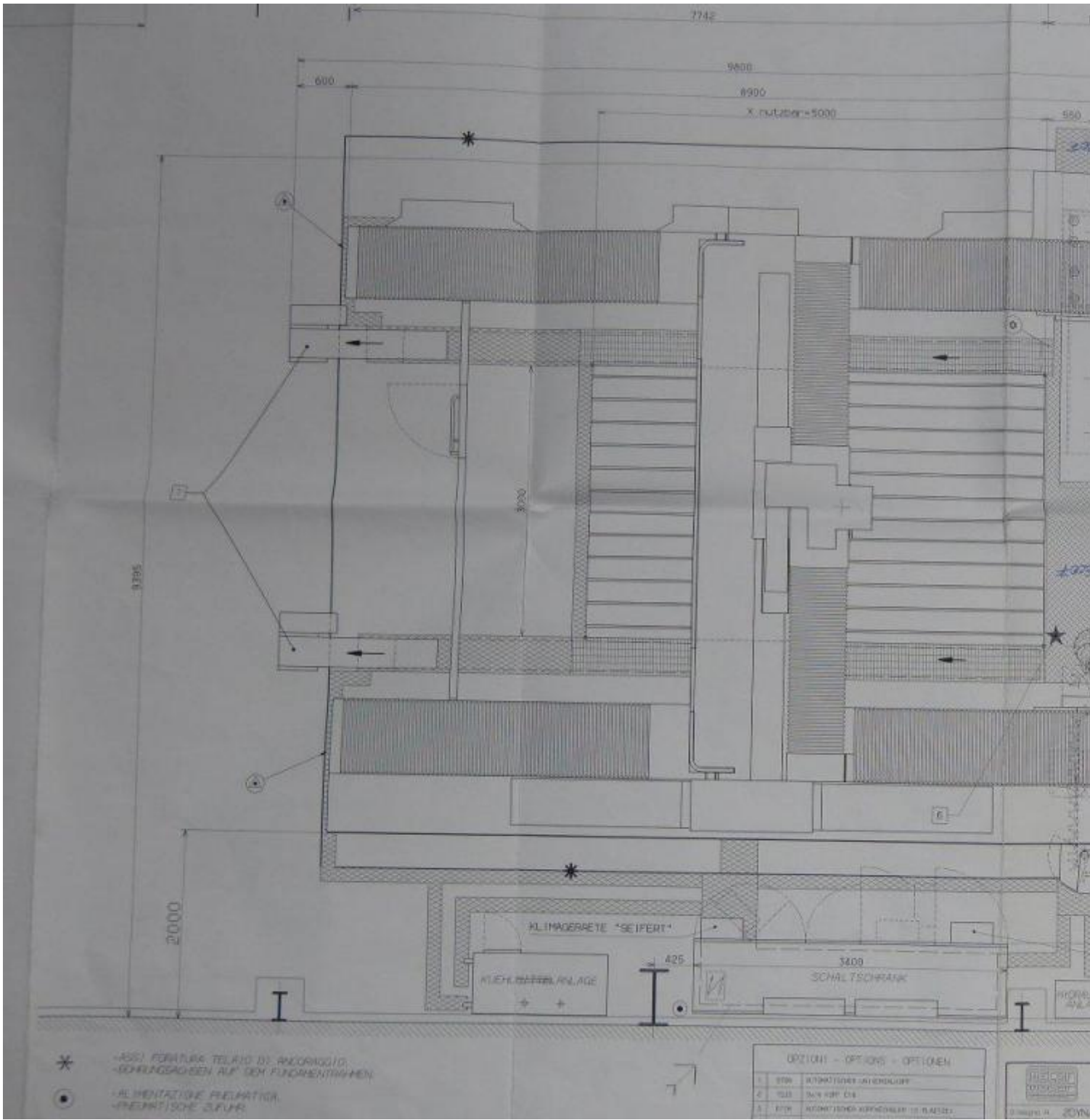

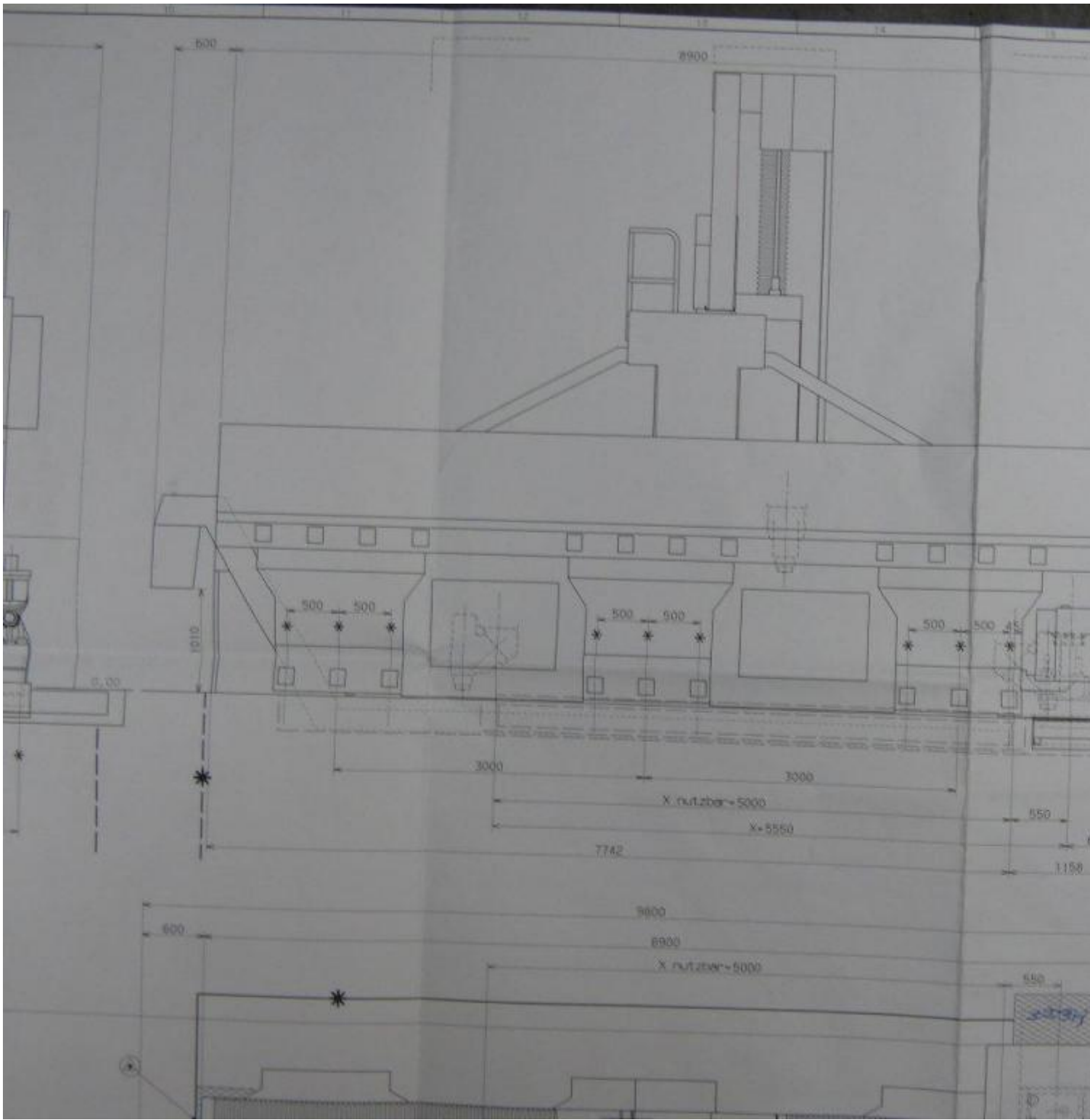



Asset-Trade

Assessment and Sale of Used Assets world wide

Am Sonnenhof 16

47800 Krefeld

Germany

Tel.: +49 2151 32500 33

Fax.: +49 2151 65 29 22

Email: [info@asset-trade.de](mailto:info@asset-trade.de)

Web.: <https://www.asset-trade.de/en>

Ref. No.:  
506-02031008

**Overview and Technical Data:**

**MECOF - Dynamill 3000 Portal Milling Machine**

**MECOF**



Year of Build:  
Jan 2000

## **Description:**

# **MECOF Dynamill 3000 - Portal Milling Machine 5 Axis**

- Control Fidia CNC M 20
- Axis: 3+2
- Travels X / Y / Z 5,500 x 3,000 x 1,500 mm
- Table 5000 x 3000 mm
- Tisch load about 15 t
- Spindle 24,000 rev / min 17,5 KW
- Rapid Feed 15000 mm/min
- Head unit:
  - GRP-electric spindle
  - Universal Head
- HSK 63a
- Toolchanger 24x
- IKZ

Machine can be visited under power.

## **Technical Data:**

### **Technical Data:**

Control:

[FIDIA](#)

Spindle Speed:

24.000 rpm

Tool Capacity:

24 x

### **Travels:**

X-Axis:

5.500 mm

Y-Axis:

3.000mm

Z-Axis:

1.500 mm

## **Dimensions and Weight:**

Weight:

30.000 kg

## **Buyer Information:**

Condition:

[Very good condition](#)

Availability:

[Sold](#)

Sold as:

[EXW \(Ex Works - Incoterm\)](#)

VAT:

[19 %](#)

Buyers Premium:

[15 %](#)

Location:

Germany

**Images:**



1





3



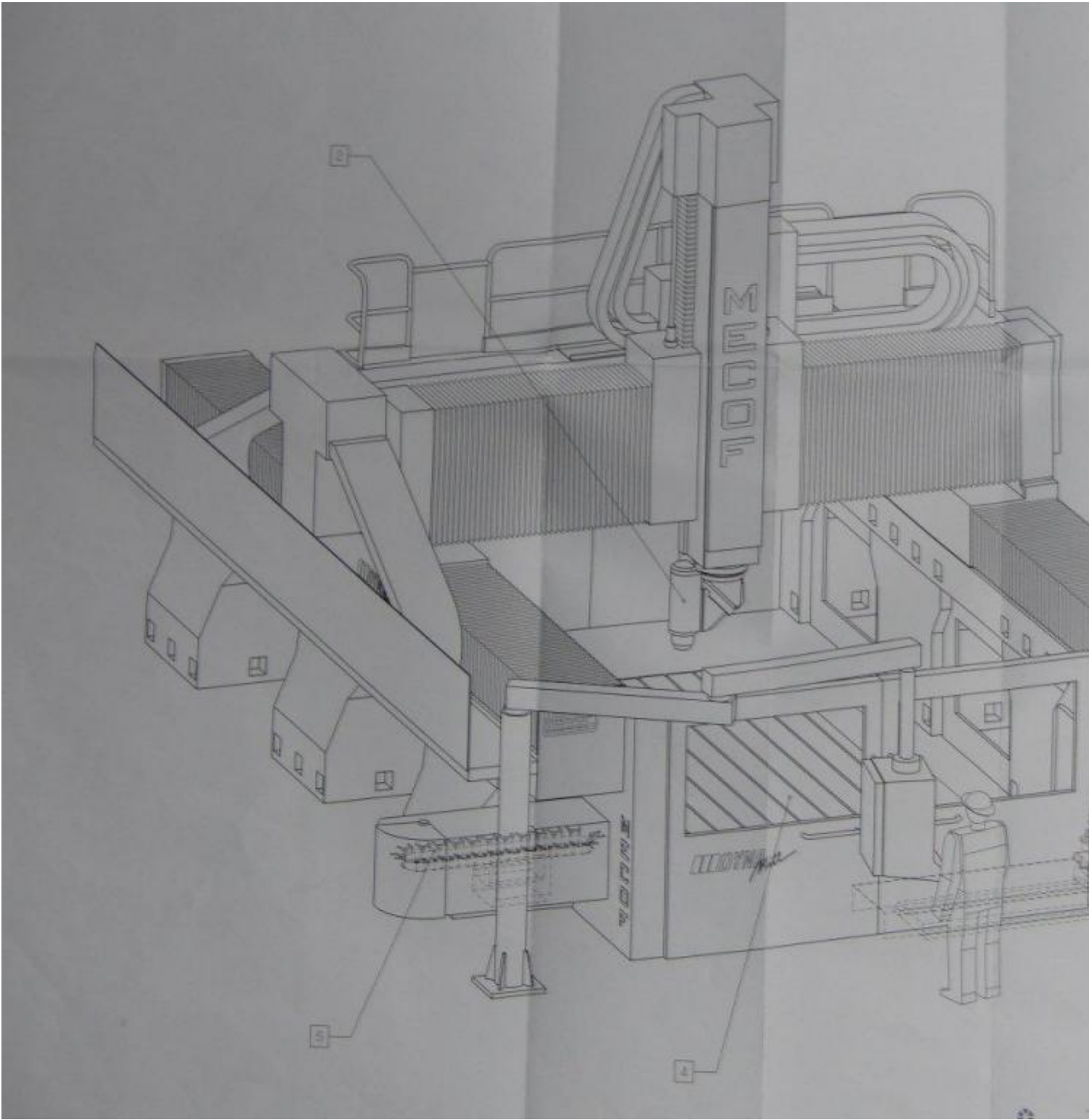

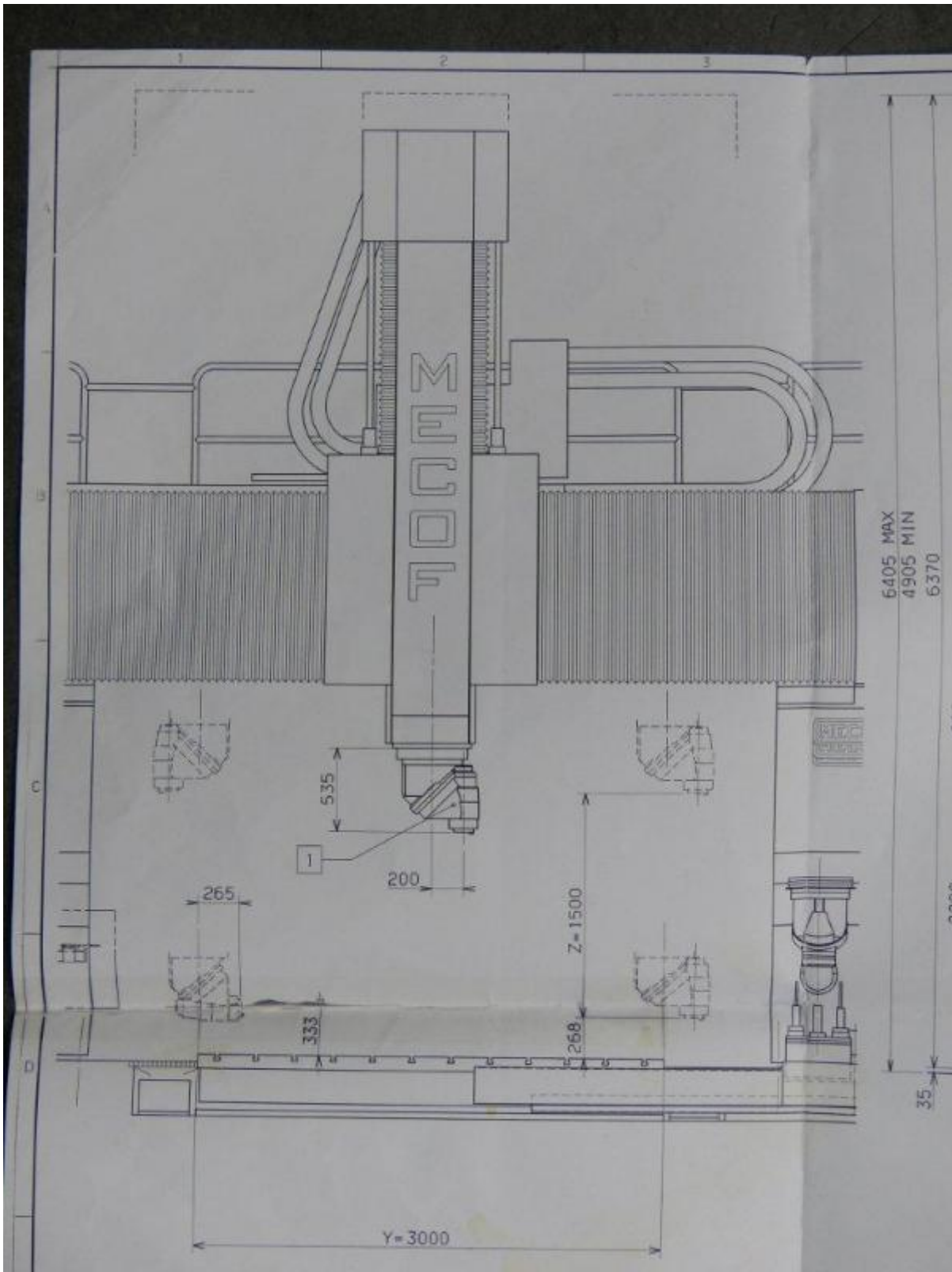

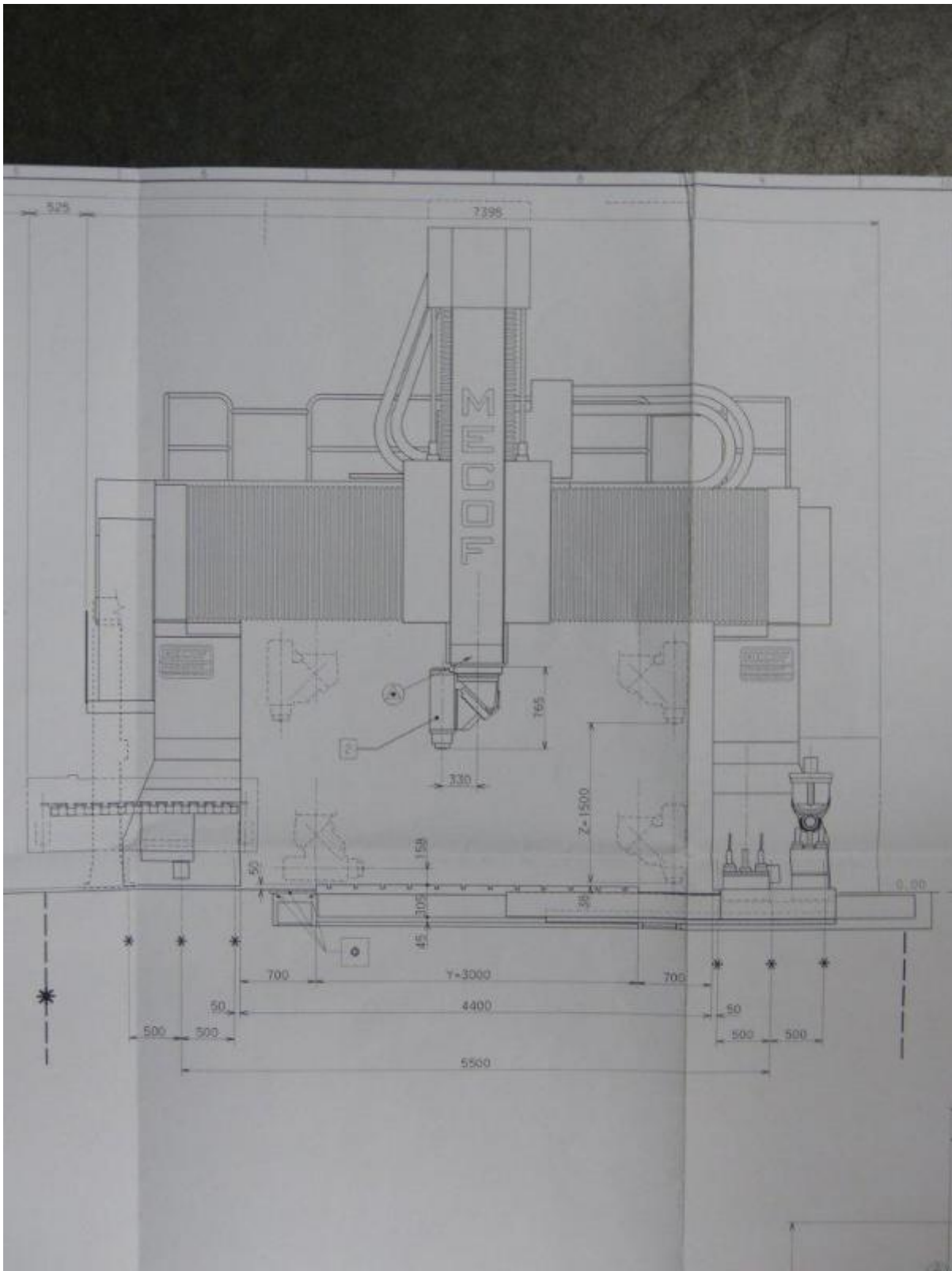

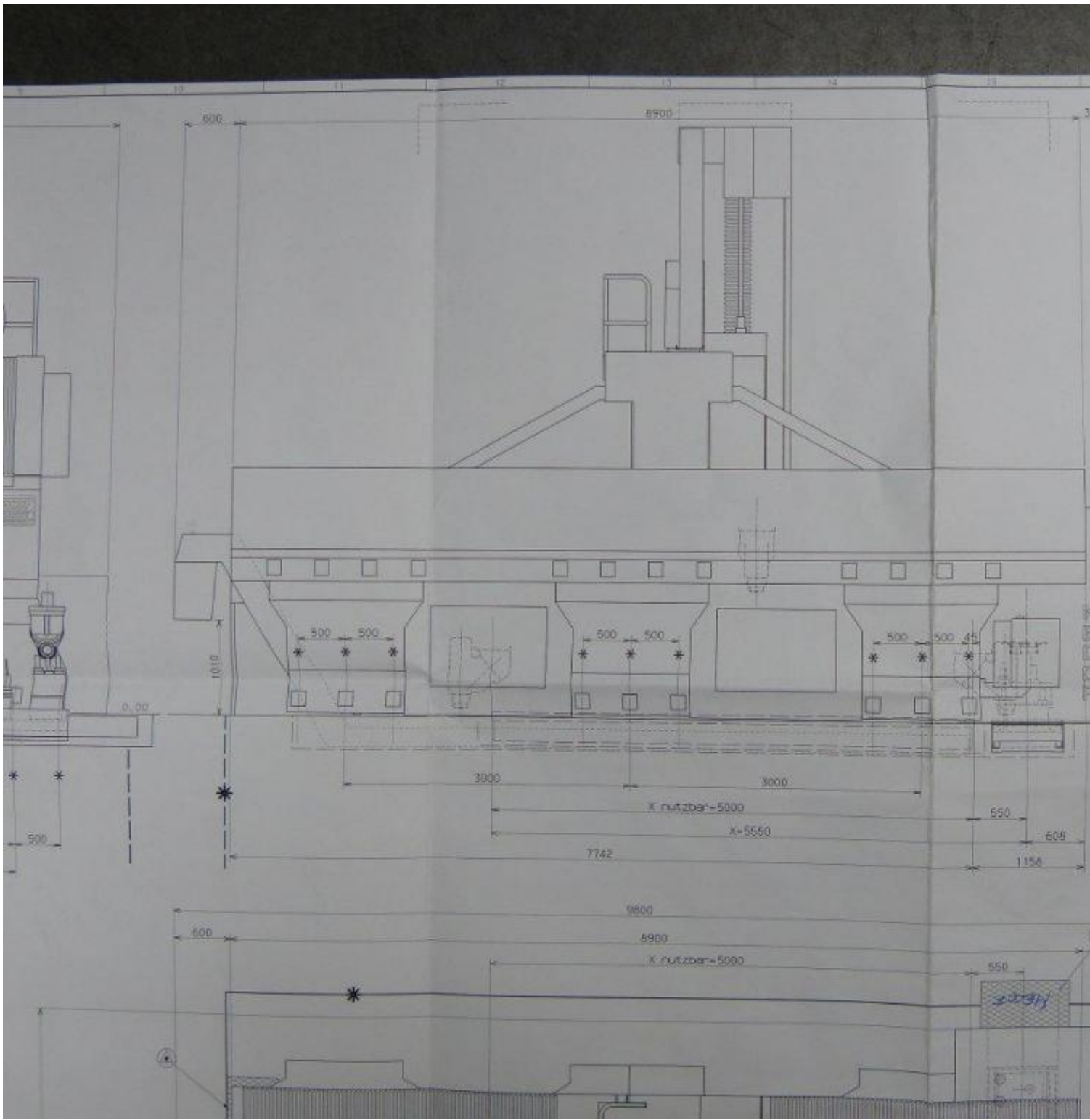

KLIMAGERÄTE "SEIFERT"

HYDRAULIK-ANLAGE

800

135



Cartella  
B66

MACCHINA

**2DYN**  
3000/L

*Mill*

Signo N. 2DYN/0251

GRUPPO AUSSENANSICHT

AGGIORN

Scala /

Sost

Scala 1:25

DENOM. PLATZBEDARFSPLAN

Comm

Aut. da Lastrino

DISEG

Aut. da /

NOTE X=5500; Y=3000; Z=1500

DI LEG

21/12/1999

A TER

15

16

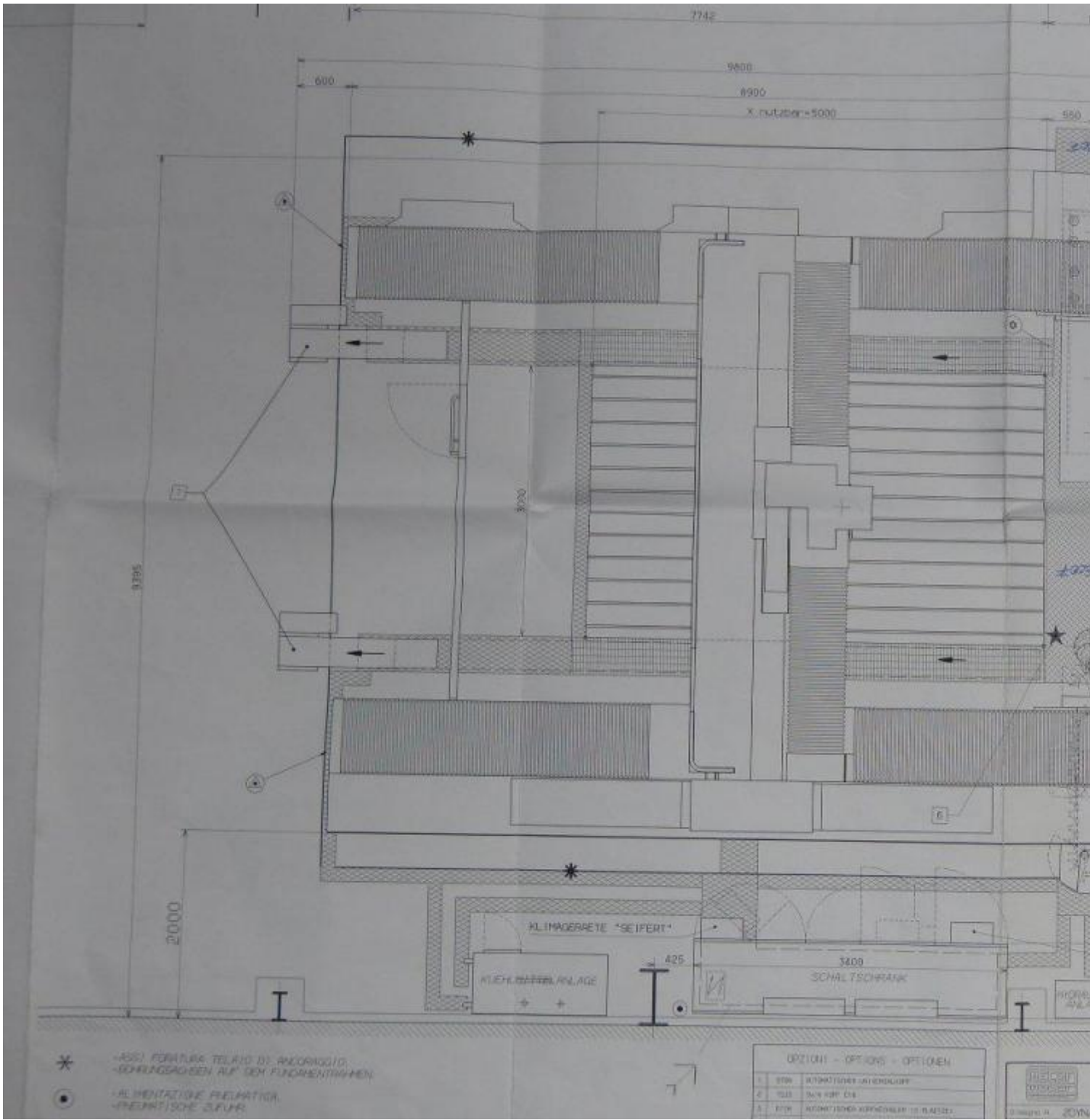





Asset-Trade

Assessment and Sale of Used Assets world wide

Am Sonnenhof 16

47800 Krefeld

Germany

Tel.: +49 2151 32500 33

Fax.: +49 2151 65 29 22

Email: [info@asset-trade.de](mailto:info@asset-trade.de)

Web.: <https://www.asset-trade.de/en>

Generated on 02.04.2026

© Copyright 2026 - [Asset-Trade](#)

Page