

Image not found or type unknown



Ref. No.:

101-08011745

Overview and Technical Data:

KOENIG + BAUER - KBA - KBA Commander II Web Offset Newspaper Press

KOENIG + BAUER - KBA



KBA

Koenig & Bauer AG

Year of Build:

Jan 1992

Description:

KBA Commander II Web Newspaper Press

- Double Circumference 1060mm, Cut Off 530mm, Double Width
- 32000 Copies/Hour
- Web Width 1440mm
- Paper Roll Diameter 1250mm
- Three Towers - Each Tower Includes 9 Cylinder Satellite with 6 Cylinder above
- KBA 'KF80' 2:3:3 Folder
- (5) KBA 'Pastomat RE2' Reel Stands
- Format Size produced 'Large Rheinisch 530mm x 1440mm'

Operating hours on Request

More information to follow soon - Fulldetails see PDF

Technical Data:

Technical Data:

Control:

[CNC](#)

Dimensions and Weight:

Weight:

350.000 kg

Buyer Information:

Condition:

[Normal wear](#)

Available:

[On Request](#)

Sold as:

[EXW \(Ex Works - Incoterm\)](#)

VAT:

[19 %](#)

Buyers Premium:

[15 %](#)

Location:

Germany

Images:



1



2



3



4



5



6



7



8



9



10



11



12



13



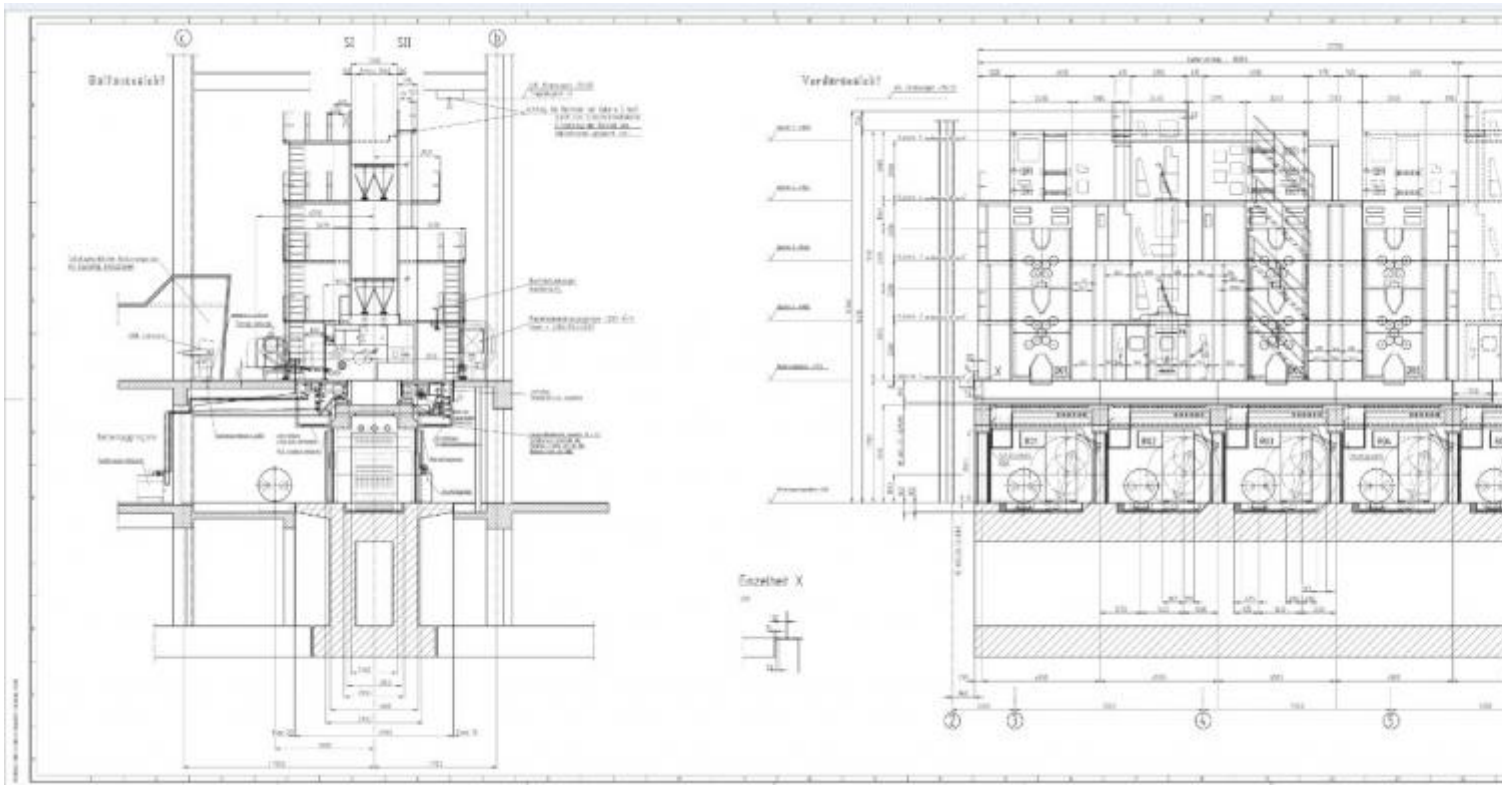

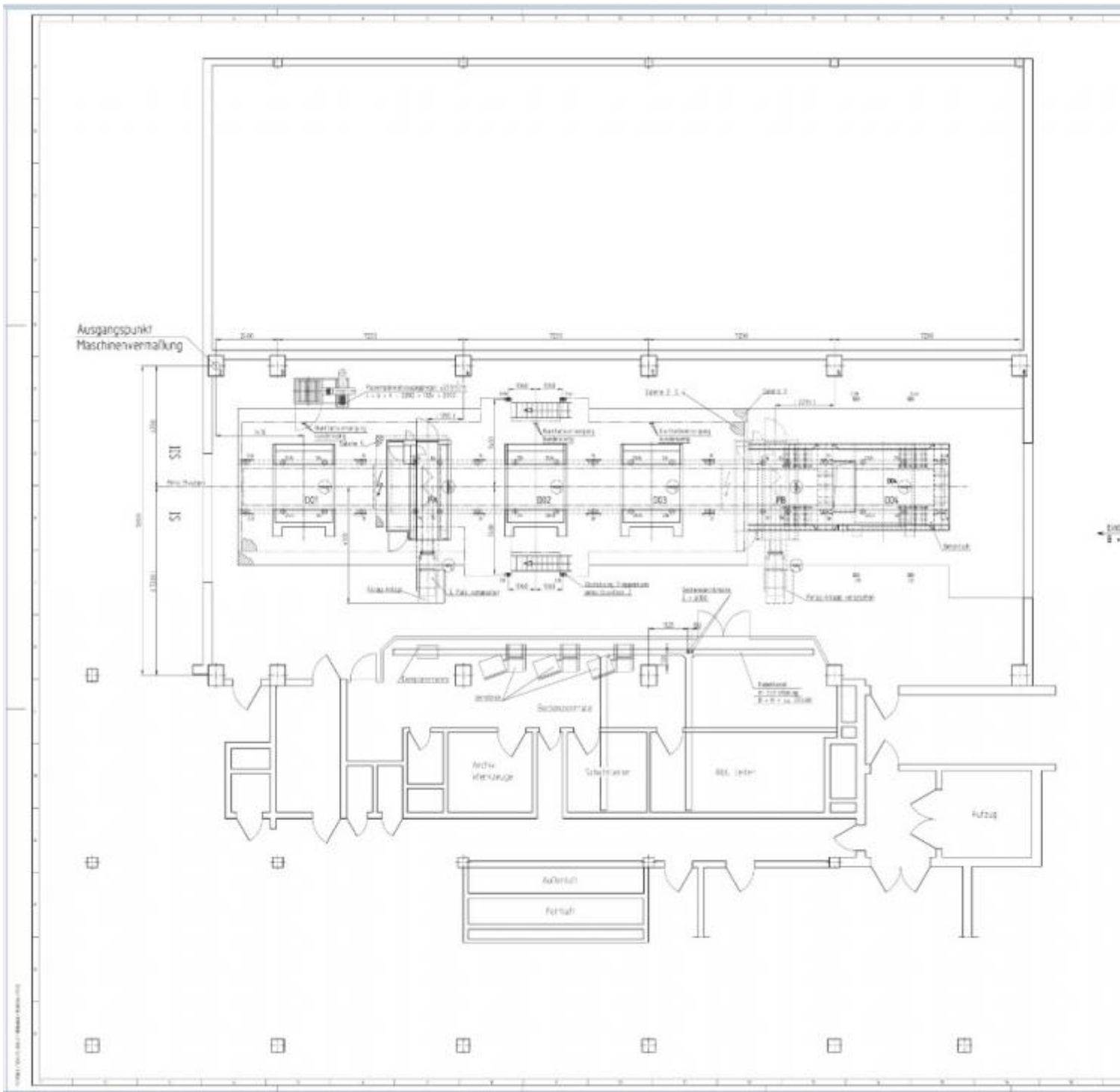

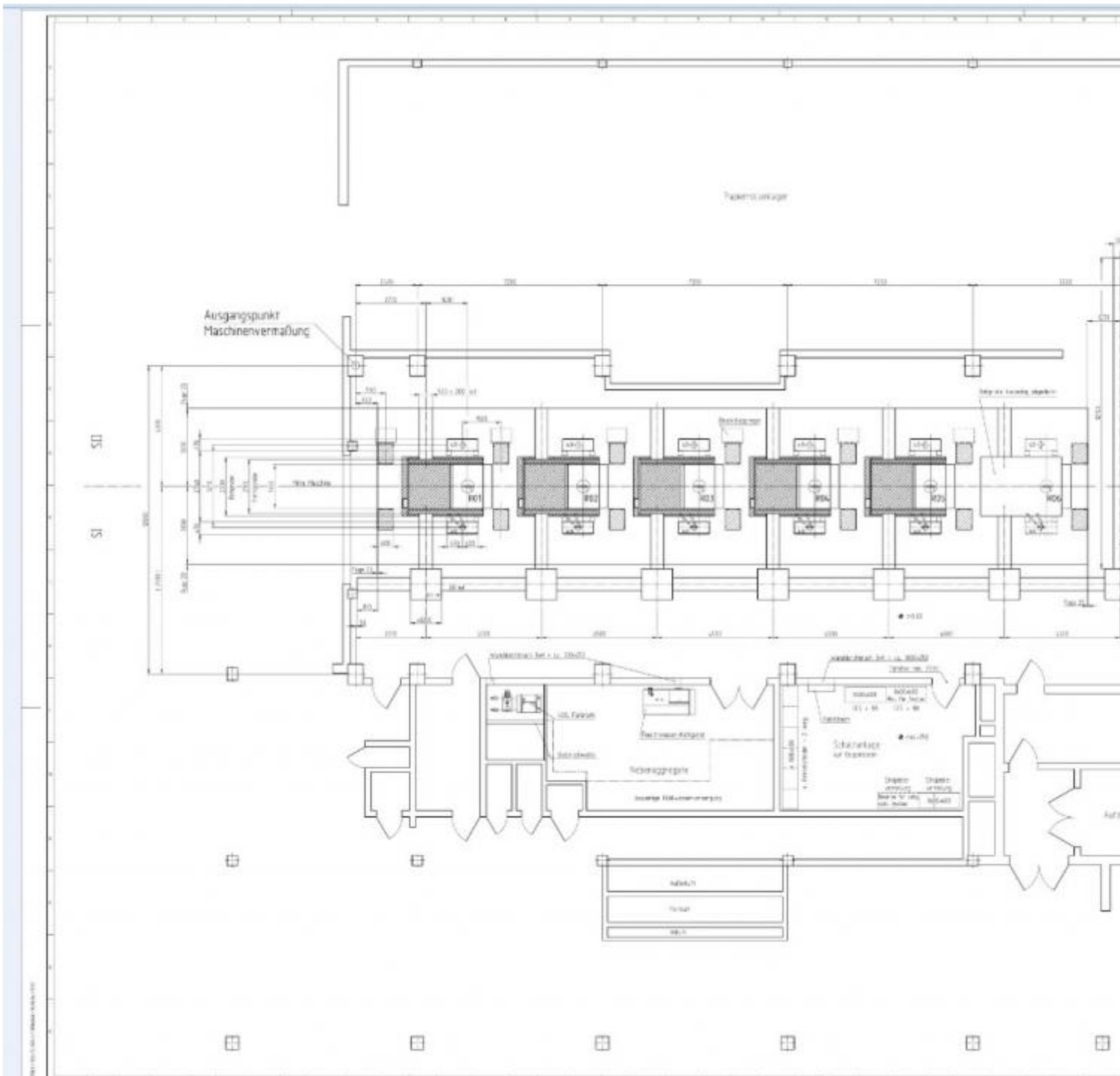

Asset-Trade

Assessment and Sale of Used Assets world wide

Am Sonnenhof 16

47800 Krefeld

Germany

Tel.: +49 2151 32500 33

Fax.: +49 2151 65 29 22

Email: info@asset-trade.de

Web.: <https://www.asset-trade.de/en>

Ref. No.:

101-08011745

Overview and Technical Data:

**KOENIG + BAUER - KBA - KBA Commander II Web Offset
Newspaper Press**

[KOENIG + BAUER - KBA](#)



KBA

Koenig & Bauer AG

Year of Build:
Jan 1992

Description:

KBA Commander II Web Newspaper Press

- Double Circumference 1060mm, Cut Off 530mm, Double Width
- 32000 Copies/Hour
- Web Width 1440mm
- Paper Roll Diameter 1250mm
- Three Towers - Each Tower Includes 9 Cylinder Satellite with 6 Cylinder above
- KBA 'KF80' 2:3:3 Folder
- (5) KBA 'Pastomat RE2' Reel Stands
- Format Size produced 'Large Rheinisch 530mm x 1440mm'

Operating hours on Request

More information to follow soon - Fulldetails see PDF

Technical Data:

Technical Data:

Control:
[CNC](#)

Dimensions and Weight:

Weight:
350.000 kg

Buyer Information:

Condition:
[Normal wear](#)
Available:
[On Request](#)
Sold as:

EXW (Ex Works - Incoterm)

VAT:

19 %

Buyers Premium:

15 %

Location:

Germany

Images:





2



3



4



5



6



7



8



9



10



11



12



13



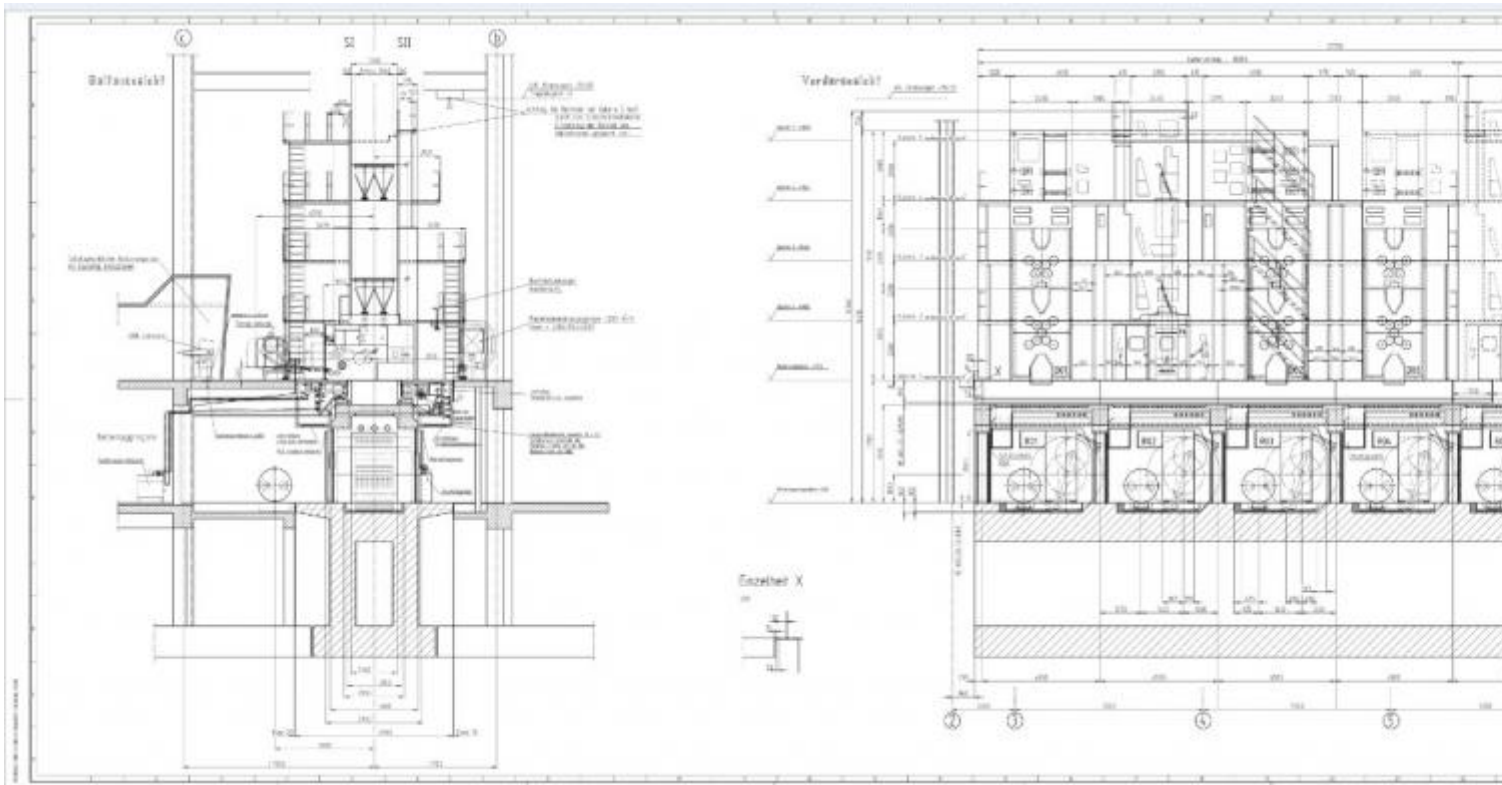

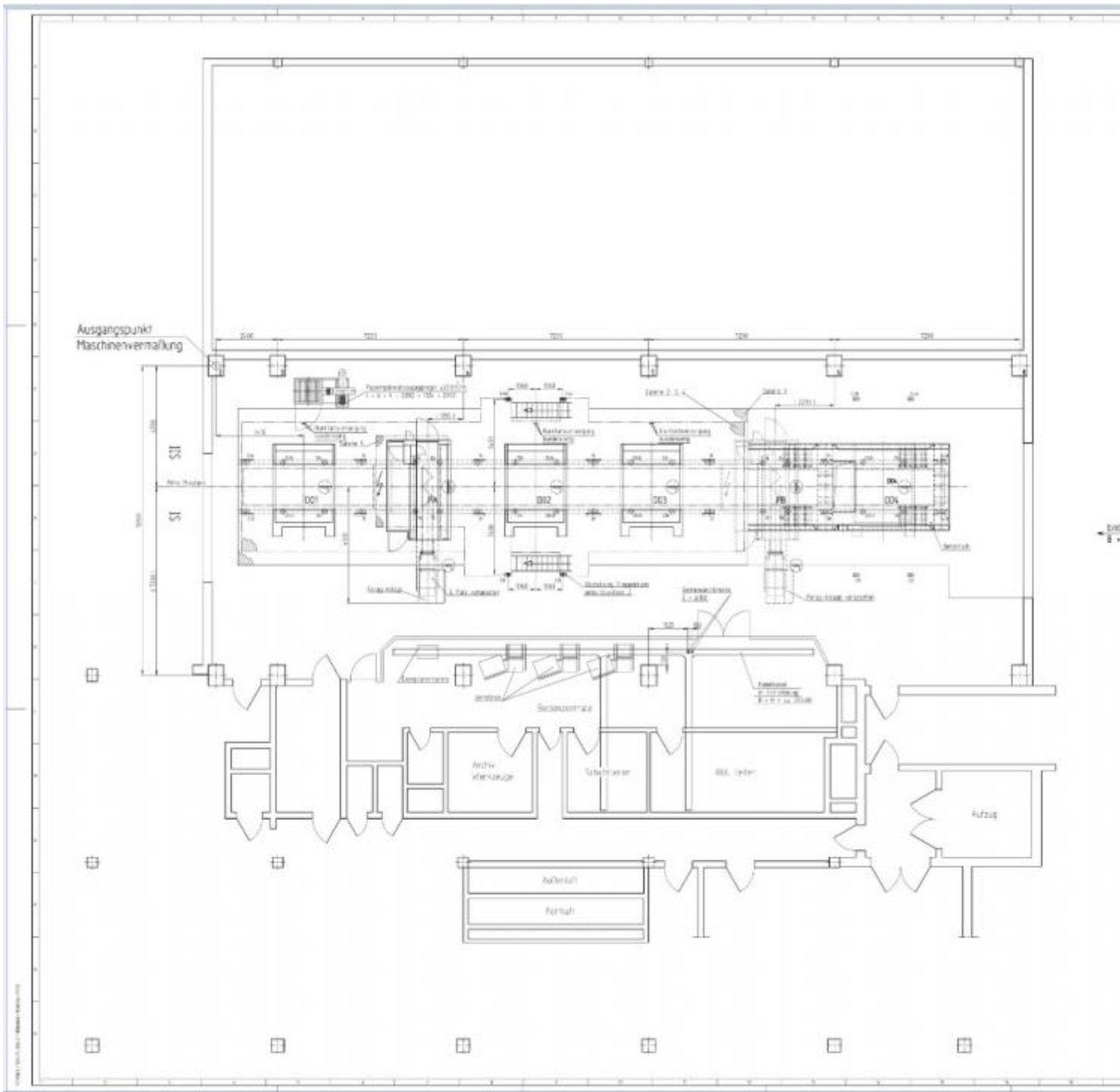

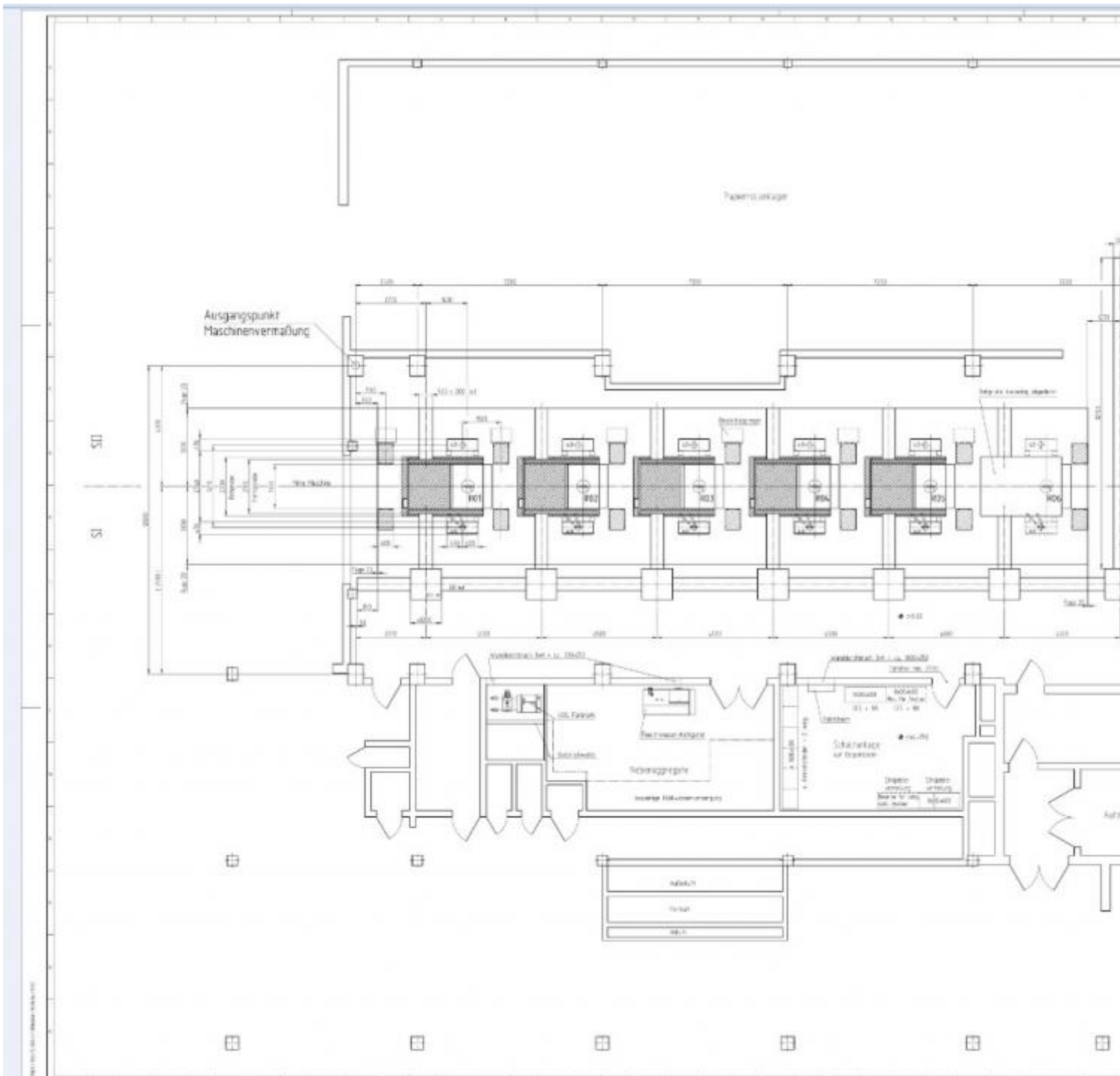

Asset-Trade

Assessment and Sale of Used Assets world wide

Am Sonnenhof 16

47800 Krefeld

Germany

Tel.: +49 2151 32500 33

Fax.: +49 2151 65 29 22

Email: info@asset-trade.de

Web.: <https://www.asset-trade.de/en>

Generated on 28.04.2026

© Copyright 2026 - [Asset-Trade](#)

Page