

Image not found or type unknown



Ref. No.:
137-0915-1111

Overview and Technical Data:

MATRA - VMC 2020

MATRA

MATRA

Year of Build:
Jan 2000

Description:

Used MATRA VMC 2020 Milling machine

Main Spindle was replaced by a new one 1 year ago!!

Technical data

- Fanuc OM control
- about 3.000 Hrs of operation
- Table size 2100 mm x 860 mm
- X-axis stroke of 2050 mm
- Y-axis stroke 900 mm
- Z-axis 710 mm
- Distance table to spindle nose 155 mm. 865 mm
- Distance spindle center-stand 635 mm (885mm)
- Tooling BT / SK-50
- Front spindle bearing diameter 90 mm
- Speed range 10-3600 rpm (10 - min 4500 rpm)
- Transmission / two-step standard
- Drive power 11/15 kW (15 / 18.5 kW)
- Rapid traverse X, Y, Z 12/12/10 m / min
- Feed range 1-4000 mm / min.
- Coolant pump 1.5 kW
- Tool encoding fixed / variable (A) Space coding
- Magazine Capacity 20 / 24A (20/24A)
- Maximum tool diameter 120 mm
- Maximum tool length 400 mm
- Max Tool Weight 15 kg
- Table load 2000 kg
- Dimensions (HxWxL) 3300 x 3765 x 5500 mm

Standard

- splash guard
- Coolant system
- Chip conveyor belt-from-VMC1124
- Work light
- Automatic. central lubrication
- Spindle Blow-out system

Special accessories

- NC rotary table
- Automatic tool measuring
- 2-fold pallet changer
- Coolant through tool d.
- Coolant through the spindle
- Spindle speed 10,000 rpm, 40-A
- Spindle speed 6,000 rpm A-50

Newprice was 180.000 Euro in 2000

Technical Data:

Technical Data:

Control:

[0i-Modell D](#)

Machine Hours:

3.000 hrs.

Spindle Speed:

3.600 rpm

Tool Holder:

[SK50](#)

Tool Capacity:

24 x

Travels:

X-Axis:

2.050 mm

Y-Axis:

900mm

Z-Axis:

710 mm

Dimensions and Weight:

Height:

5.500 mm

Width:

3.765 mm

Length:

3.300 mm

Weight:

16.000 kg

Buyer Information:

Condition:

[Normal wear](#)

Availability:

[Immediately](#)

Sold as:

[EXW \(Ex Works - Incoterm\)](#)

VAT:

[19 %](#)

Buyers Premium:

[15 %](#)

Location:

Germany

Images:



1











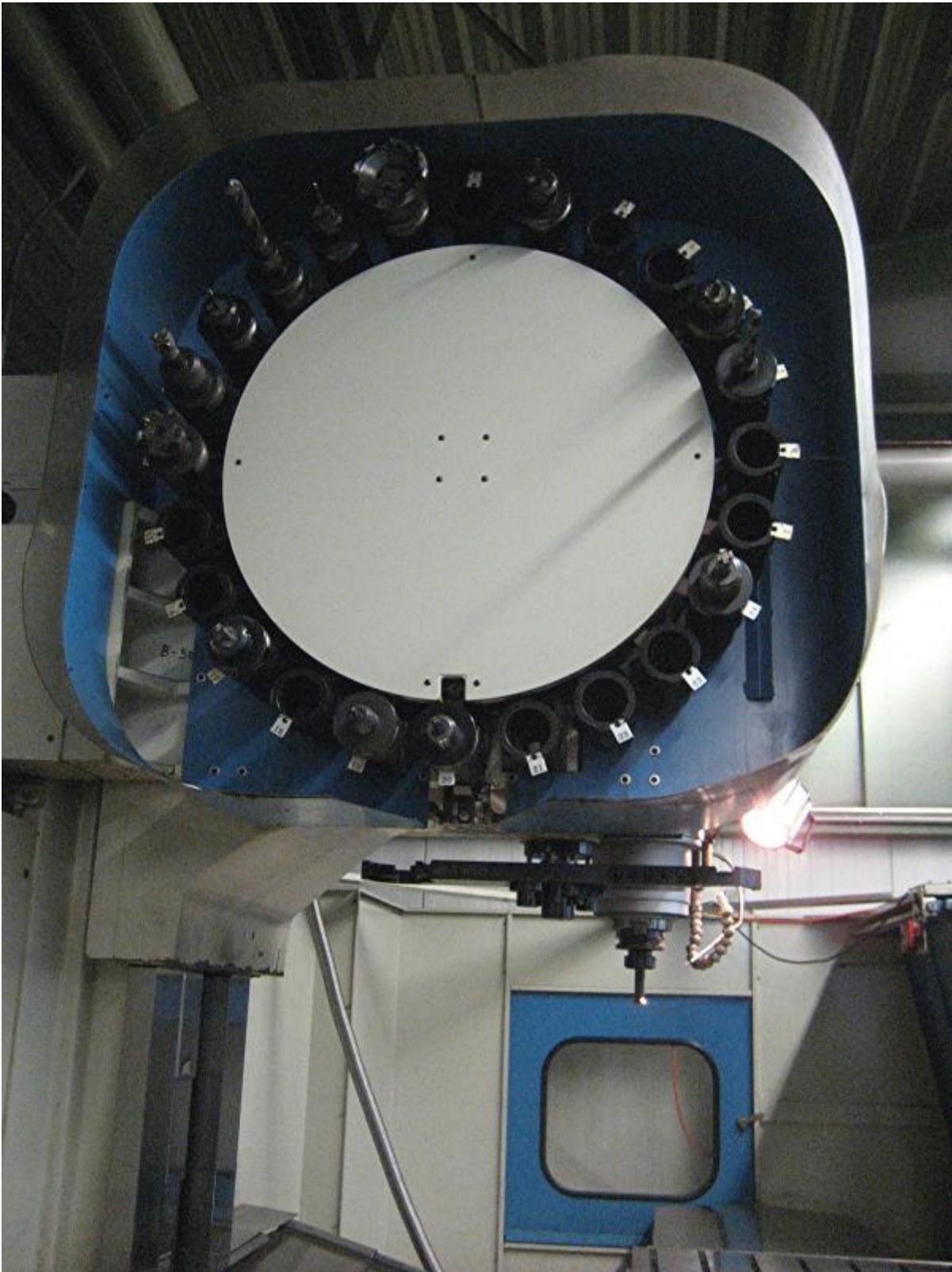

1-1 Technische Daten

Spezifikation	MODELL	VMC-2020 / 2024A / 2000(HD)
Tischgröße		2.100 mm x 860 mm
X-Achsenweg		2.050 mm
Y-Achsenweg		900 mm
Z-Achsenweg		710 mm
Abstand Tisch-Spindelnase		155 mm - 865 mm
Abstand Spindelmitte-Ständer		635 mm (885 mm)
Werkzeugaufnahme		BT/SK-50
Durchm. vorderes Spindellager		90 mm
Drehzahlbereich		10 - 3.600 U/min (10 - 4.500 U/min)
Getriebe / 2-Stufen		Standard
Antriebsleistung		11 / 15 kW (15 / 18.5 kW)
Eilgang X,Y,Z		12 / 12 / 10 m/min
Vorschubbereich		1 - 4.000 mm/min
Kühlmittelpumpe		1,5 kW
Werkzeugeodierung		feste / variable(A) Platzcodierung
Magazinplätze		20 / 24A (20 / 24A)
max. Werkzeug-Durchmesser		120 mm
max. Werkzeug-Länge		400 mm
max. Werkzeug-Gewicht		15 kg
Tischbelastung		2.000 kg
Maschinengewicht		16.000 kg
Platzbedarf B x T		5.500 mm x 3.764 mm

Standardausführung

- Vollspritzschutz
- Kühlmitteleinrichtung
- Schrauben-Späneförderer-ab VMC1124
- Arbeitsleuchte
- Autom. Zentralschmierung
- Spindelausblaseinrichtung

Sonderzubehör

- NC-Rundtisch
- Autom. Werkzeugvermessen
- 2-fach Palettenwechsler (VMC-550/1324)
- Kühlmittelzufuhr durch d. Werkzeug
- Kühlmittelzufuhr durch die Spindel
- Spindeldrehzahl 10.000U/min-A 40
- Spindeldrehzahl 6.000U/min-A 50

MATRA

2-6

VMC-2020/2024A/2000HD

X- / Z-Achsenwege

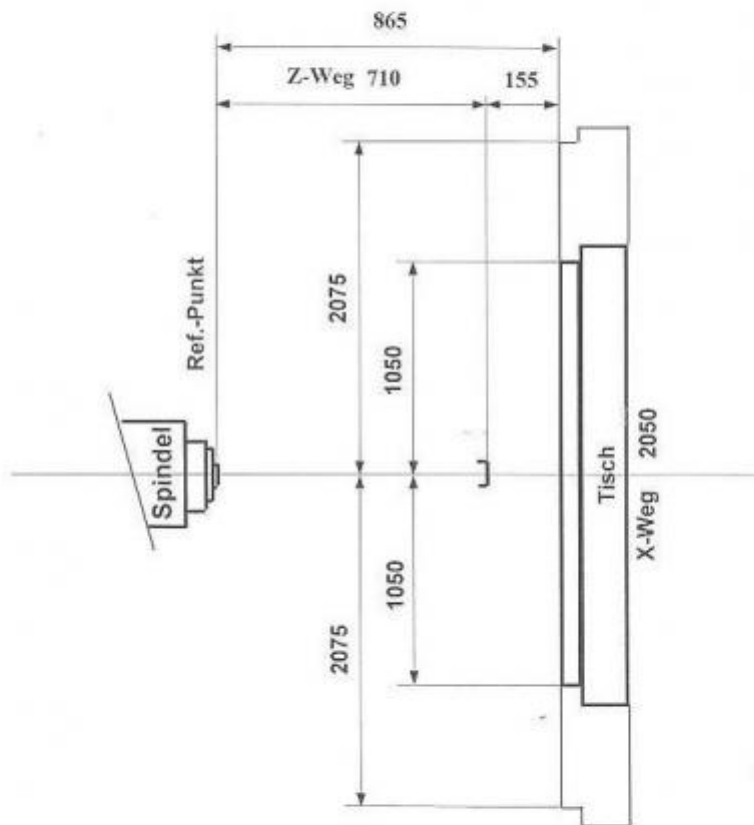

**1-3 Maschinen-Abmessungen:
VNC-2020 / 2024 / 2024A**

Höhenmaße incl. Stellfüße
Stellfußhöhe = 50 mm

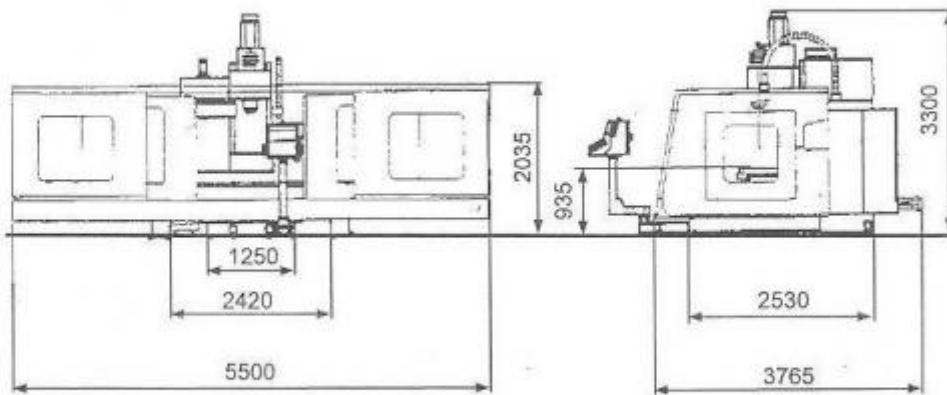
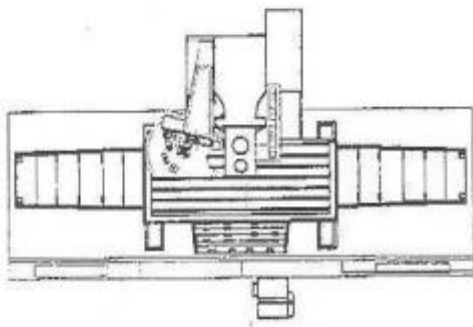

MATRA

2-8

Arbeitstisch & T-Nuten

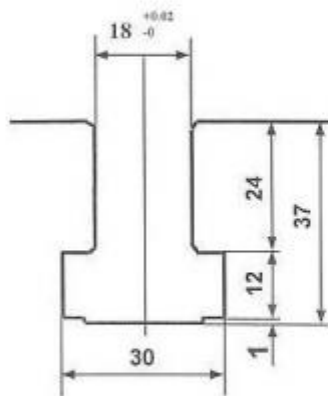
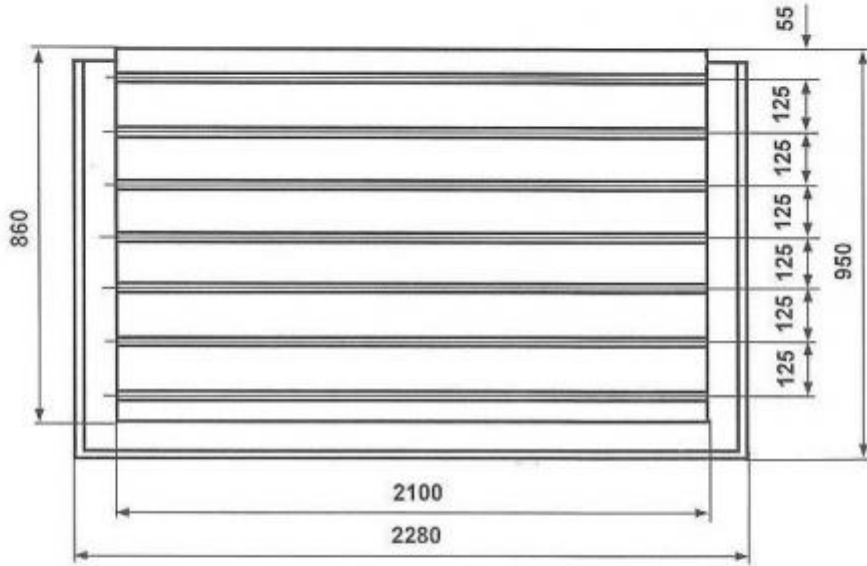

VMC-2020/2024A/2000HD

Y- / Z-Achsenwege

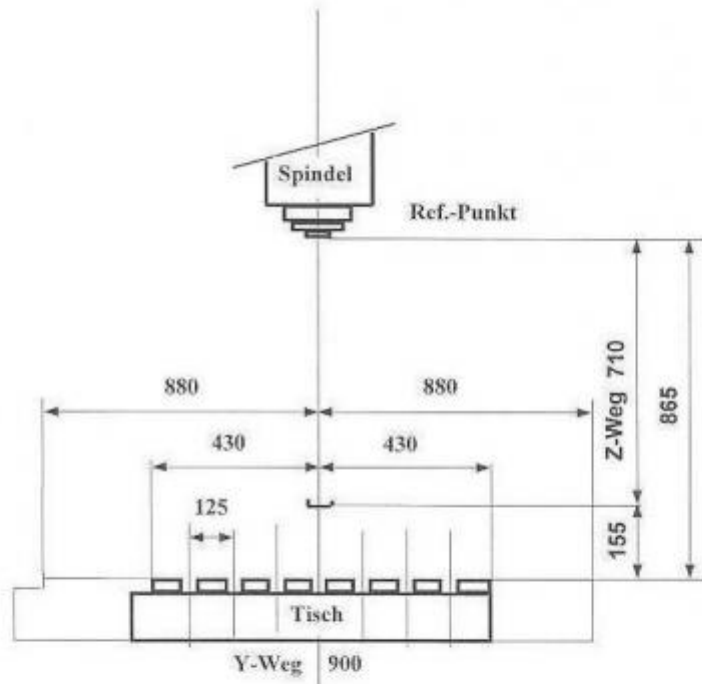



Asset-Trade

Assessment and Sale of Used Assets world wide

Am Sonnenhof 16

47800 Krefeld

Germany

Tel.: +49 2151 32500 33

Fax.: +49 2151 65 29 22

Email: info@asset-trade.de

Web.: <https://www.asset-trade.de/en>

Ref. No.:
137-0915-1111

Overview and Technical Data:

MATRA - VMC 2020

MATRA

MATRA

Year of Build:

Jan 2000

Description:

Used MATRA VMC 2020 Milling machine

Main Spindle was replaced by a new one 1 year ago!!

Technical data

- Fanuc OM control
- about 3.000 Hrs of operation
- Table size 2100 mm x 860 mm
- X-axis stroke of 2050 mm
- Y-axis stroke 900 mm
- Z-axis 710 mm
- Distance table to spindle nose 155 mm. 865 mm
- Distance spindle center-stand 635 mm (885mm)
- Tooling BT / SK-50
- Front spindle bearing diameter 90 mm
- Speed range 10-3600 rpm (10 - min 4500 rpm)
- Transmission / two-step standard
- Drive power 11/15 kW (15 / 18.5 kW)
- Rapid traverse X, Y, Z 12/12/10 m / min
- Feed range 1-4000 mm / min.
- Coolant pump 1.5 kW
- Tool encoding fixed / variable (A) Space coding
- Magazine Capacity 20 / 24A (20/24A)
- Maximum tool diameter 120 mm
- Maximum tool length 400 mm
- Max Tool Weight 15 kg
- Table load 2000 kg
- Dimensions (HxWxL) 3300 x 3765 x 5500 mm

Standard

- splash guard
- Coolant system
- Chip conveyor belt-from-VMC1124
- Work light
- Automatic. central lubrication
- Spindle Blow-out system

Special accessories

- NC rotary table

- Automatic tool measuring
- 2-fold pallet changer
- Coolant through tool d.
- Coolant through the spindle
- Spindle speed 10,000 rpm, 40-A
- Spindle speed 6,000 rpm A-50

Newprice was 180.000 Euro in 2000

Technical Data:

Technical Data:

Control:

[0i-Modell D](#)

Machine Hours:

3.000 hrs.

Spindle Speed:

3.600 rpm

Tool Holder:

[SK50](#)

Tool Capacity:

24 x

Travels:

X-Axis:

2.050 mm

Y-Axis:

900mm

Z-Axis:

710 mm

Dimensions and Weight:

Height:

5.500 mm

Width:

3.765 mm

Length:

3.300 mm

Weight:

16.000 kg

Buyer Information:

Condition:

[Normal wear](#)

Availability:

[Immediately](#)

Sold as:

EXW (Ex Works - Incoterm)

VAT:

19 %

Buyers Premium:

15 %

Location:

Germany

Images:













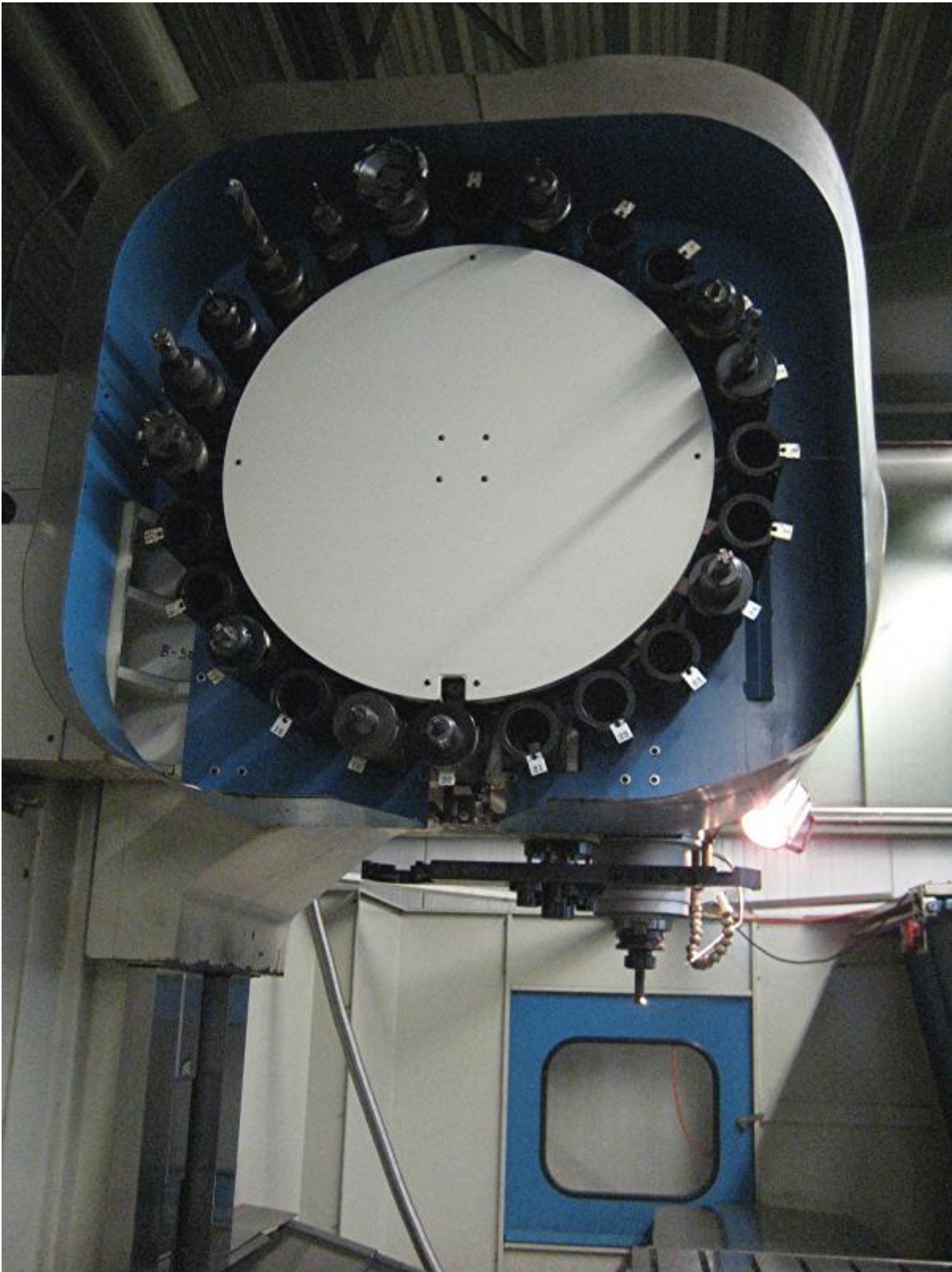

1-1 Technische Daten

Spezifikation	MODELL	VMC-2020 / 2024A / 2000(HD)
Tischgröße		2.100 mm x 860 mm
X-Achsenweg		2.050 mm
Y-Achsenweg		900 mm
Z-Achsenweg		710 mm
Abstand Tisch-Spindelnase		155 mm - 865 mm
Abstand Spindelmitte-Ständer		635 mm (885 mm)
Werkzeugaufnahme		BT/SK-50
Durchm. vorderes Spindellager		90 mm
Drehzahlbereich		10 - 3.600 U/min (10 - 4.500 U/min)
Getriebe / 2-Stufen		Standard
Antriebsleistung		11 / 15 kW (15 / 18.5 kW)
Eilgang X,Y,Z		12 / 12 / 10 m/min
Vorschubbereich		1 - 4.000 mm/min
Kühlmittelpumpe		1.5 kW
Werkzeugeodierung		feste / variable(A) Platzcodierung
Magazinplätze		20 / 24A (20 / 24A)
max. Werkzeug-Durchmesser		120 mm
max. Werkzeug-Länge		400 mm
max. Werkzeug-Gewicht		15 kg
Tischbelastung		2.000 kg
Maschinengewicht		16.000 kg
Platzbedarf B x T		5.500 mm x 3.764 mm

Standardausführung

- Vollspritzschutz
- Kühlmitteleinrichtung
- Schrauben-Späneförderer-ab VMC1124
- Arbeitsleuchte
- Autom. Zentralschmierung
- Spindelausblaseinrichtung

Sonderzubehör

- NC-Rundtisch
- Autom. Werkzeugvermessen
- 2-fach Palettenwechsler (VMC-550/1324)
- Kühlmittelzufuhr durch d. Werkzeug
- Kühlmittelzufuhr durch die Spindel
- Spindeldrehzahl 10.000U/min-A 40
- Spindeldrehzahl 6.000U/min-A 50

MATRA

2-6

VMC-2020/2024A/2000HD

X- / Z-Achsenwege

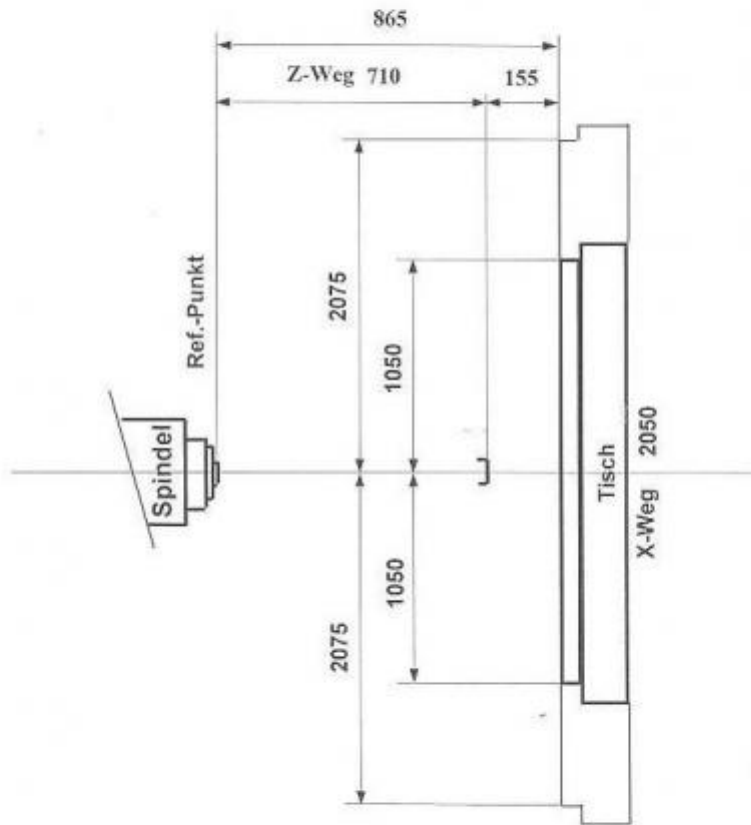

**1-3 Maschinen-Abmessungen:
VNC-2020 / 2024 / 2024A**

Höhenmaße incl. Stellfüße
Stellfußhöhe = 50 mm

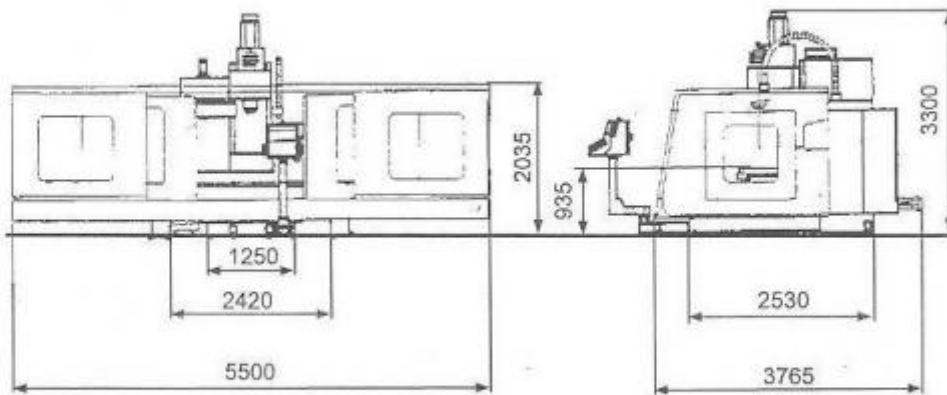
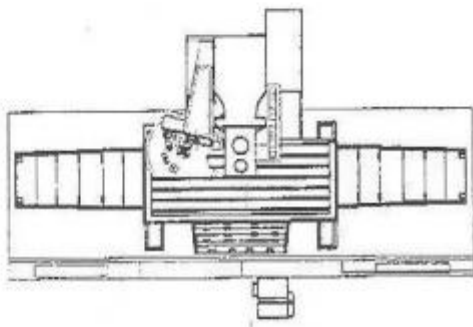

MATRA

2-8

Arbeitstisch & T-Nuten

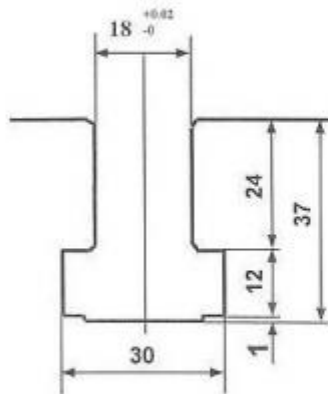
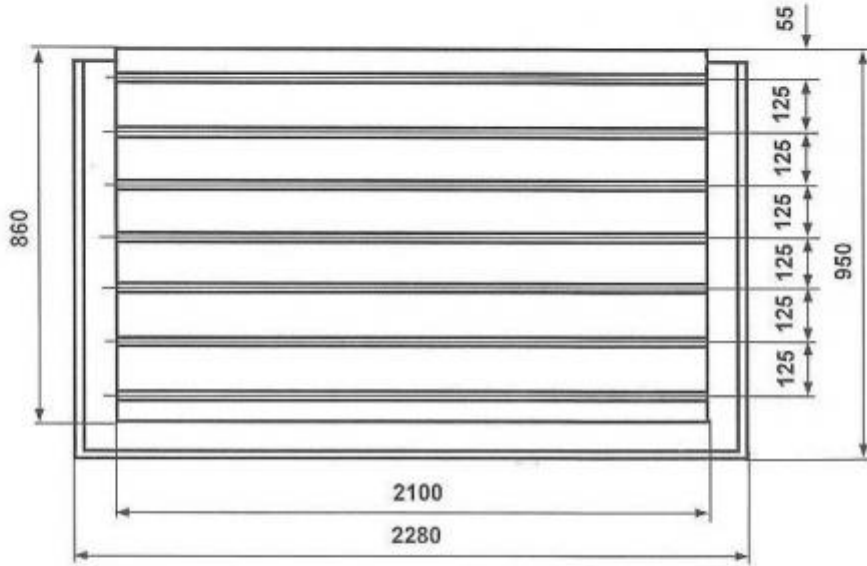

VMC-2020/2024A/2000HD

Y- / Z-Achsenwege

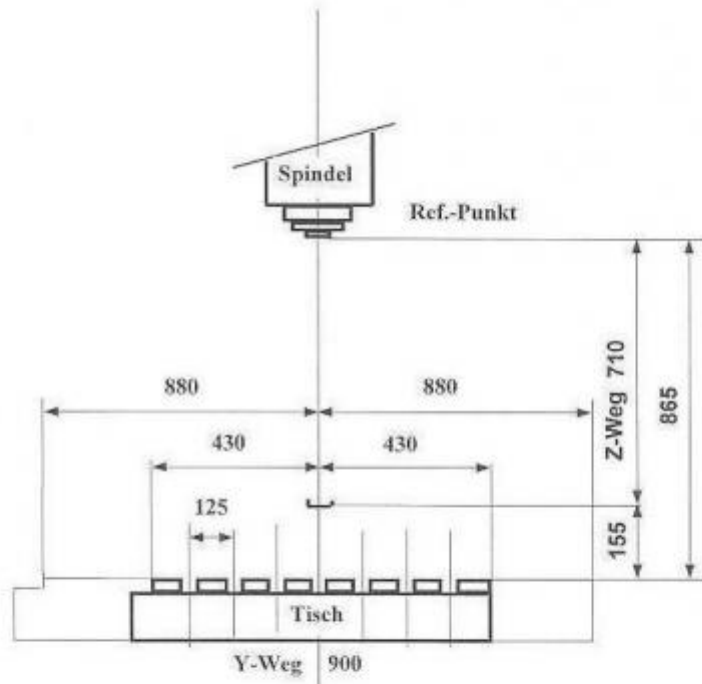



Asset-Trade

Assessment and Sale of Used Assets world wide

Am Sonnenhof 16

47800 Krefeld

Germany

Tel.: +49 2151 32500 33

Fax.: +49 2151 65 29 22

Email: info@asset-trade.de

Web.: <https://www.asset-trade.de/en>

Generated on 03.04.2026

© Copyright 2026 - [Asset-Trade](#)

Page