

Image not found or type unknown



Ref. No.:
1525-0780800

Overview and Technical Data:

2019 CMZ TD35Y CNC-lathe

CMZ



Year of Build:
Jan 2019

Description:

Used CMZ TD-35Y CNC Lathe: Power, Precision, and Reliability for Complex Machining

State-of-the-art Fanuc CNC Control

Discover the ultimate in turning performance with the CMZ TD-35Y. Designed for demanding production environments, this machine combines tremendous power with exceptional precision—based on CMZ's 80 years of manufacturing experience. Part of the renowned TD series, the TD-35Y integrates a Y-axis and driven tools, enabling complex, multi-axis machining in a single setup. This drastically reduces cycle times and increases efficiency.

Key Features

Unmatched Rigidity and Stability: The foundation of every TD series machine is the highly rigid, monoblock cast iron machine bed. This one-piece design, paired with robust prism guides, provides excellent vibration damping, resulting in outstanding surface finishes and longer tool life.

- **Advanced Thermal Control:** CMZ has developed a comprehensive cooling system to ensure exceptional thermal stability.
 - **Integrated Spindle Cooling:** The main spindle motor is integrated directly into the headstock and features oil cooling. This eliminates belts and pulleys, ensuring quieter and more reliable operation.
 - **Axis Cooling:** The ball screw nuts and mounts of the X and Y axes are oil-cooled.
- Baseplate Sensor:** A temperature sensor in the baseplate continuously monitors and regulates the temperature of the cooling oil for the spindles, nuts, and turret.
- Laser Compensation:** Each machine features bidirectional and interpolated laser compensation on all axes, including the C-axis, for consistent accuracy.

- **High-Performance Spindle:** The integrated spindle motor delivers impressive power and torque with shorter acceleration and deceleration times. This design significantly increases accuracy and improves machining efficiency.
- **Dynamic Turret with Live Tools:** The turret is designed for speed, power, and precision.
- **High-speed indexing:** Tool changes take just 0.2 seconds for adjacent positions and 0.5 seconds for a 180° rotation.
- **Powerful driven tools:** The built-in motor delivers 12,000 rpm, 13 kW of power, and 105 Nm of torque for demanding milling, drilling, and threading operations.
- **Hydraulic clamping:** A robust hydraulic system ensures stable tool clamping and maximum performance.
Oil cooling: The entire turret is oil-cooled, ensuring greater thermal stability during extended use.

Technical Specifications: CMZ TD-35Y

Capacity

- Max. Swing Diameter Over Bed: 950 mm
- Max. Turning Diameter: 715 mm
- Max. Turning Length (Z800 / Z1350): 800 mm / 1350 mm

Main Spindle

- Spindle Head: ASA A2-8"
- Spindle Speed: 3,000 rpm
- Bar Capacity: 95 mm
- Recommended Chuck Size: 315 / 400 mm
- Motor power (S3 25% / S1): 48 kW / 39 kW
- Max. torque (Max. / S3 25% / S1): 1500 Nm / 1273 Nm / 1035 Nm

Axes

- X-axis travel: 380 mm
- Z-axis travel: 800 mm / 1350 mm
- Y-axis travel: ±80 mm
- Rapid traverse (X, Z, Y): 30 m/min, 30 m/min, 15 m/min

Turret & Live Tooling

- Number of Stations: 16
- Toolholder Type: BMT
- Live Tool Speed: 12,000 rpm
- Live Tool Power: 13 kW
- Live Tool Torque: 105 Nm

To learn more about how the CMZ TD-35Y can revolutionize your production, please contact us.

Technical Data:

Technical Data:

Control:
[FANUC](#)

Turning length:
1350.00 mm
Turning diameter:
800.00 mm
Spindle Speed:
12000.00 rpm
Driven Tools:
16.00
Tool Capacity:
16 x
Tailstock:
Yes
Bezel:
Yes

Dimensions and Weight:

Height:
1900 mm
Length:
2803 mm
Width:
1930 mm

Buyer Information:

Condition:
[Very good condition](#)
Available:
[Sold](#)
Sold as:
[EXW \(Ex Works - Incoterm\)](#)
VAT:
[19 %](#)
Buyers Premium:
[18 %](#)
Location:
Germany

Images:











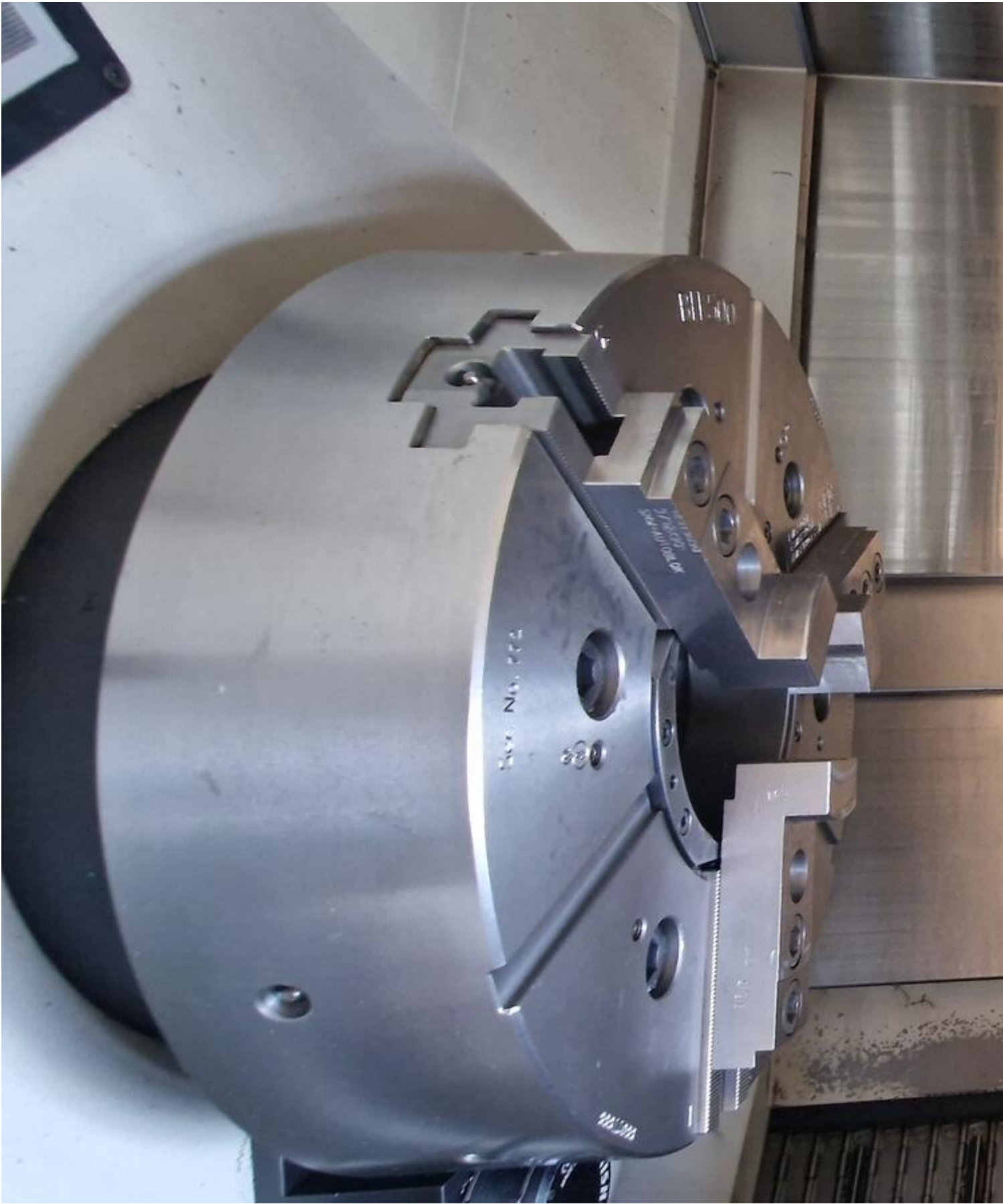







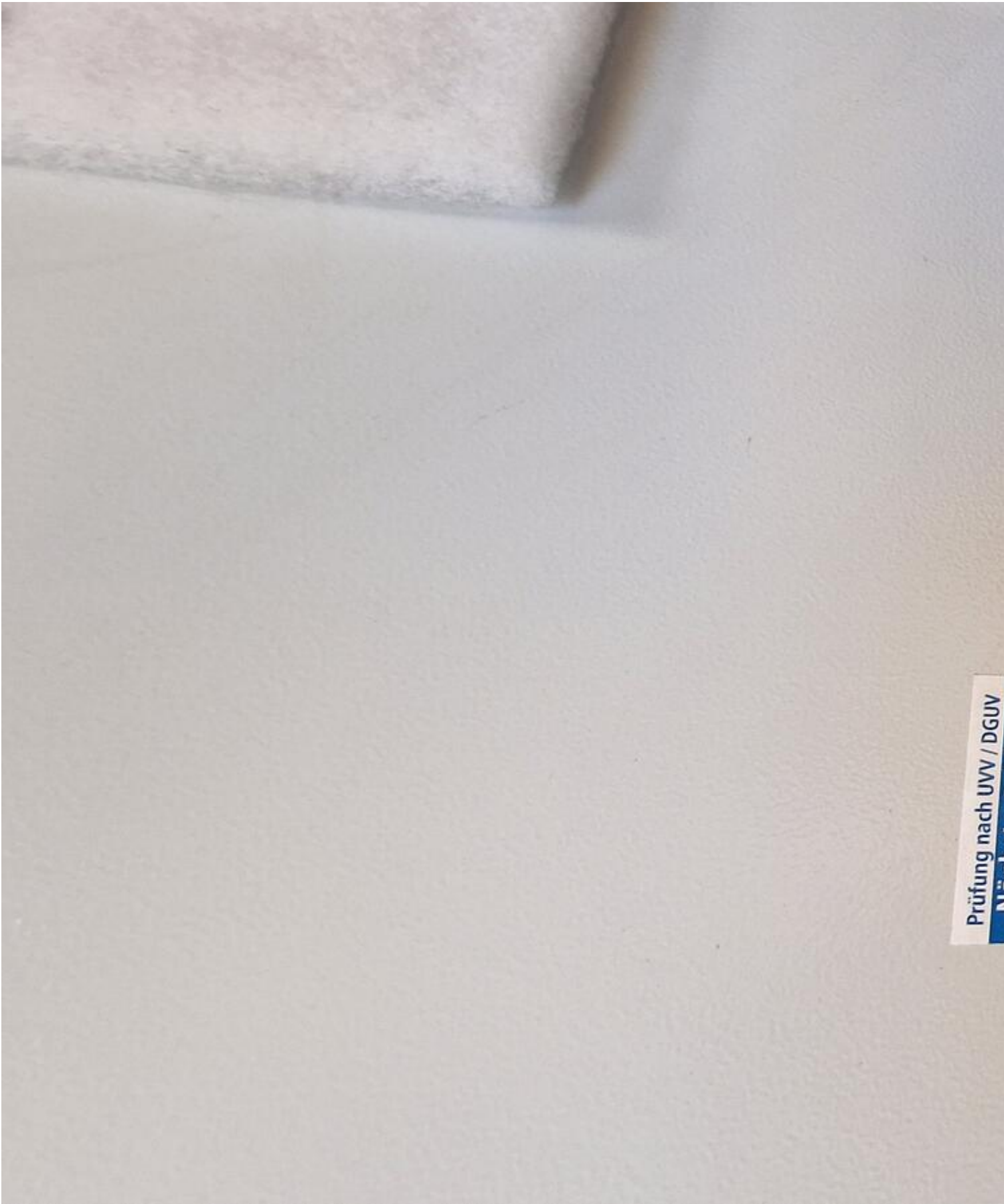





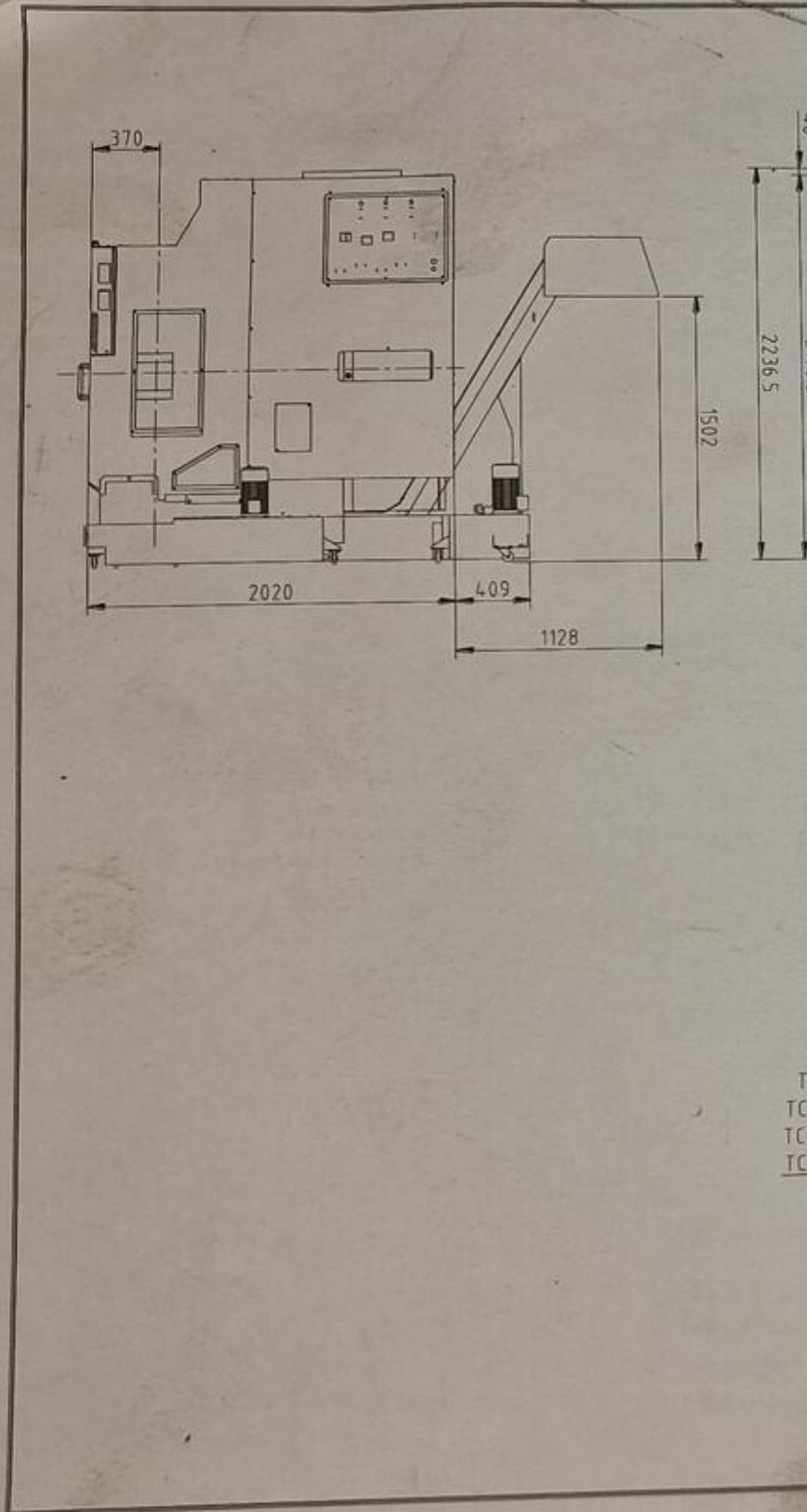

13

Video:



Asset-Trade

Assessment and Sale of Used Assets world wide

Am Sonnenhof 16

47800 Krefeld

Germany

Tel.: +49 2151 32500 33

Fax.: +49 2151 65 29 22

Email: info@asset-trade.de

Web.: <https://www.asset-trade.de/en>

Ref. No.:
1525-0780800

Overview and Technical Data:

2019 CMZ TD35Y CNC-lathe

CMZ



Year of Build:
Jan 2019

Description:

Used CMZ TD-35Y CNC Lathe: Power, Precision, and Reliability for Complex Machining

State-of-the-art Fanuc CNC Control

Discover the ultimate in turning performance with the CMZ TD-35Y. Designed for demanding production environments, this machine combines tremendous power with exceptional precision—based on CMZ's 80 years of manufacturing experience. Part of the renowned TD series, the TD-35Y integrates a Y-axis and driven tools, enabling complex, multi-axis machining in a single setup. This drastically reduces cycle times and increases efficiency.

Key Features

Unmatched Rigidity and Stability: The foundation of every TD series machine is the highly rigid, monoblock cast iron machine bed. This one-piece design, paired with robust prism guides, provides excellent vibration damping, resulting in outstanding surface finishes and longer tool life.

- **Advanced Thermal Control:** CMZ has developed a comprehensive cooling system to ensure exceptional thermal stability.

- **Integrated Spindle Cooling:** The main spindle motor is integrated directly into the headstock and features oil cooling. This eliminates belts and pulleys, ensuring quieter and more reliable operation.
- **Axis Cooling:** The ball screw nuts and mounts of the X and Y axes are oil-cooled.
Baseplate Sensor: A temperature sensor in the baseplate continuously monitors and regulates the temperature of the cooling oil for the spindles, nuts, and turret.
- **Laser Compensation:** Each machine features bidirectional and interpolated laser compensation on all axes, including the C-axis, for consistent accuracy.
- **High-Performance Spindle:** The integrated spindle motor delivers impressive power and torque with shorter acceleration and deceleration times. This design significantly increases accuracy and improves machining efficiency.
- **Dynamic Turret with Live Tools:** The turret is designed for speed, power, and precision.
- **High-speed indexing:** Tool changes take just 0.2 seconds for adjacent positions and 0.5 seconds for a 180° rotation.
- **Powerful driven tools:** The built-in motor delivers 12,000 rpm, 13 kW of power, and 105 Nm of torque for demanding milling, drilling, and threading operations.
- **Hydraulic clamping:** A robust hydraulic system ensures stable tool clamping and maximum performance.
Oil cooling: The entire turret is oil-cooled, ensuring greater thermal stability during extended use.

Technical Specifications: CMZ TD-35Y

Capacity

- Max. Swing Diameter Over Bed: 950 mm
- Max. Turning Diameter: 715 mm
- Max. Turning Length (Z800 / Z1350): 800 mm / 1350 mm

Main Spindle

- Spindle Head: ASA A2-8"
- Spindle Speed: 3,000 rpm
- Bar Capacity: 95 mm
- Recommended Chuck Size: 315 / 400 mm
- Motor power (S3 25% / S1): 48 kW / 39 kW
- Max. torque (Max. / S3 25% / S1): 1500 Nm / 1273 Nm / 1035 Nm

Axes

- X-axis travel: 380 mm
- Z-axis travel: 800 mm / 1350 mm
- Y-axis travel: ±80 mm
- Rapid traverse (X, Z, Y): 30 m/min, 30 m/min, 15 m/min

Turret & Live Tooling

- Number of Stations: 16
- Toolholder Type: BMT
- Live Tool Speed: 12,000 rpm
- Live Tool Power: 13 kW
- Live Tool Torque: 105 Nm

To learn more about how the CMZ TD-35Y can revolutionize your production, please contact us.

Technical Data:

Technical Data:

Control:

[FANUC](#)

Turning length:

1350.00 mm

Turning diameter:

800.00 mm

Spindle Speed:

12000.00 rpm

Driven Tools:

16.00

Tool Capacity:

16 x

Tailstock:

Yes

Bezel:

Yes

Dimensions and Weight:

Height:

1900 mm

Length:

2803 mm

Width:

1930 mm

Buyer Information:

Condition:

[Very good condition](#)

Available:

[Sold](#)

Sold as:

[EXW \(Ex Works - Incoterm\)](#)

VAT:

[19 %](#)

Buyers Premium:

[18 %](#)

Location:

Germany

Images:



















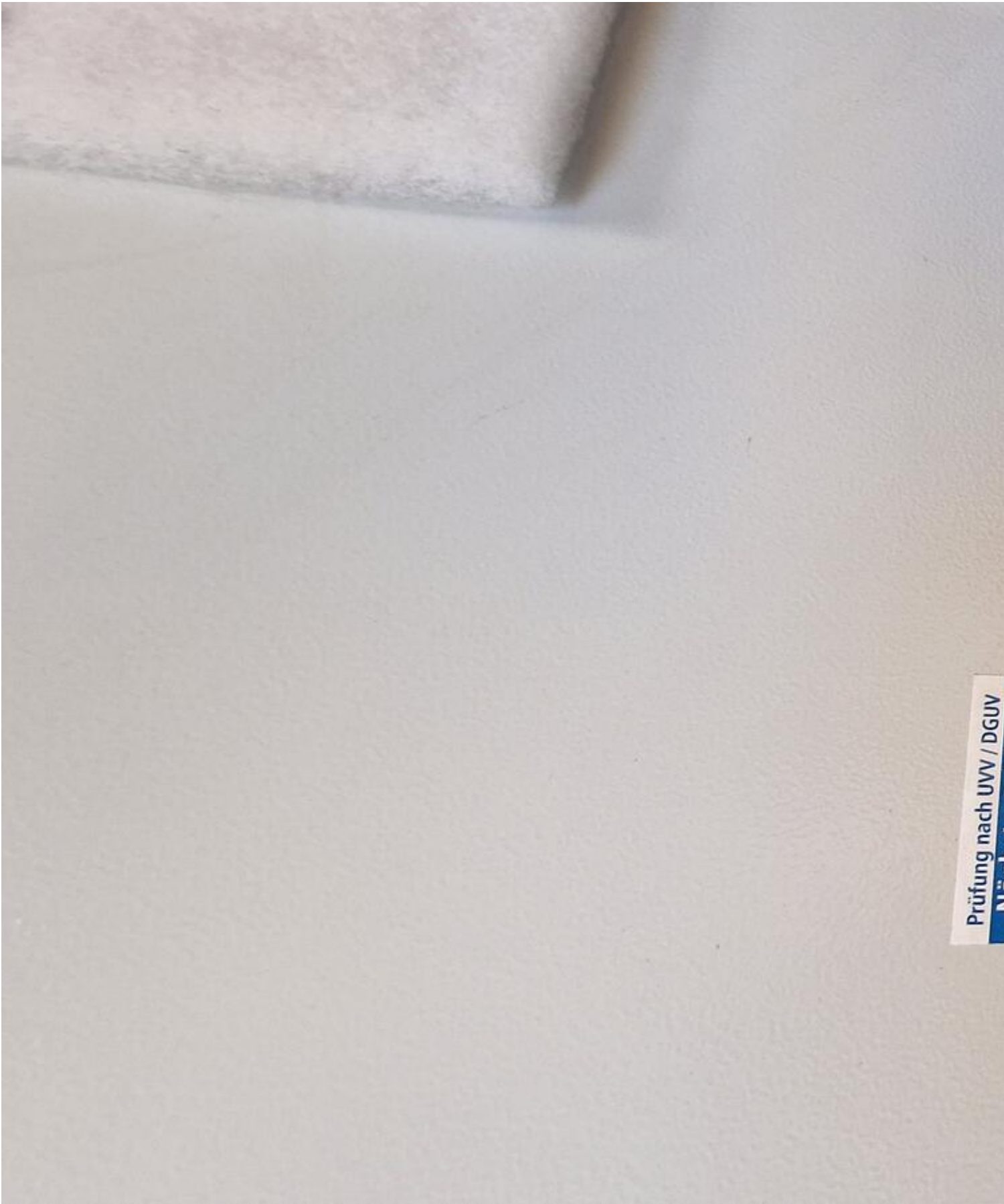





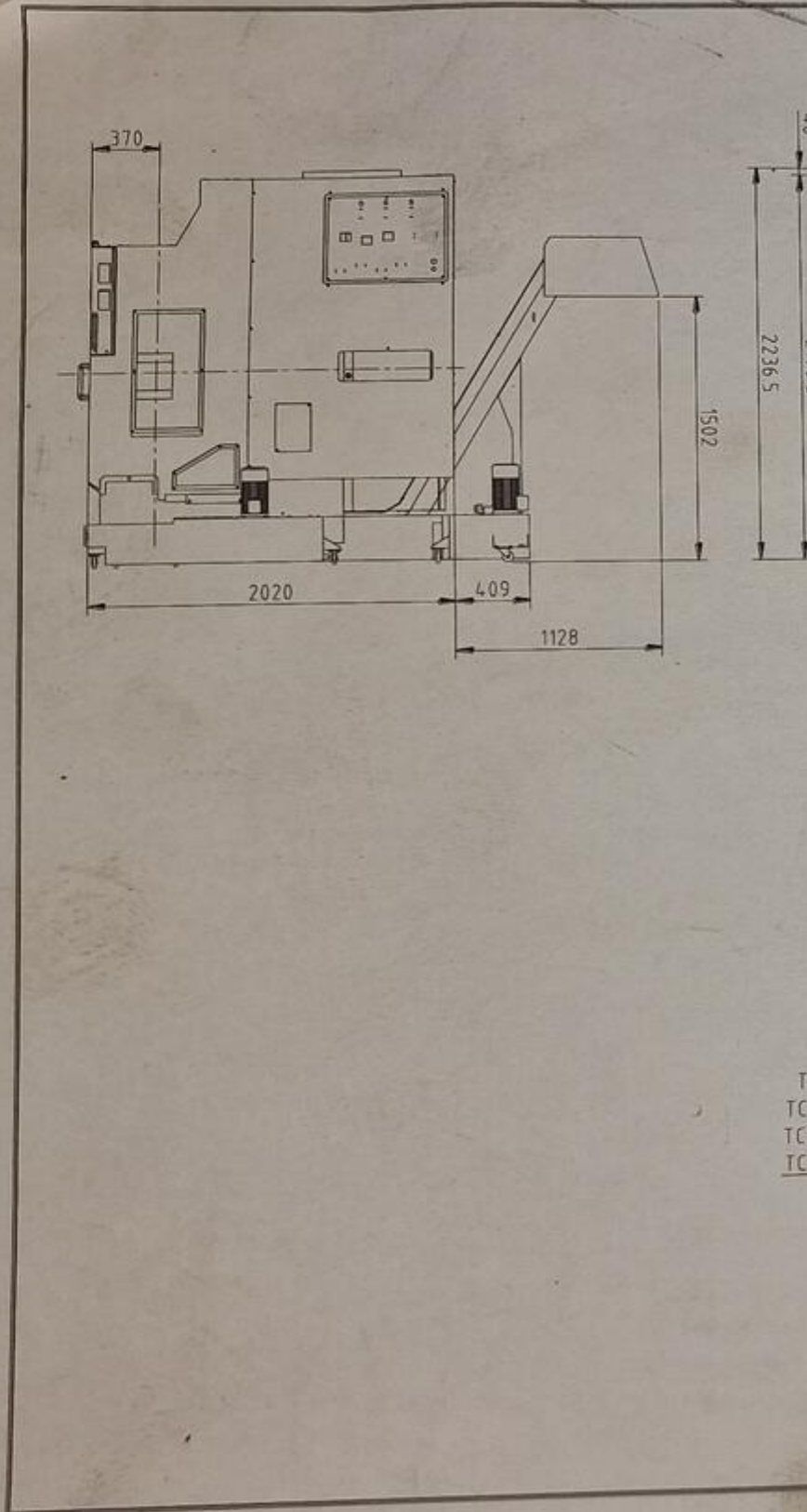

13

Video:



Asset-Trade

Assessment and Sale of Used Assets world wide

Am Sonnenhof 16

47800 Krefeld

Germany

Tel.: +49 2151 32500 33

Fax.: +49 2151 65 29 22

Email: info@asset-trade.de

Web.: <https://www.asset-trade.de/en>

Generated on 15.04.2026

© Copyright 2026 - [Asset-Trade](#)

Page