



Asset-Trade

Assessment & Sale of Used Assets

Ref. No.: 202-1101618

Overview and Technical Data:

SW / EMAG - BA 40 5850 vertical machining center

SW



Year of Build: Jan 1996



Description:

Used SCHWÄBISCHE WERKZEUGMASCHINEN SW BA40 X=5850 - vertical machining center (manufacturing front axle)

Metrics and technical performance data:

- Control: SINUMERIK 840 C
- Drive power 36 KW
- Total power 50 kW
- Feed rate 25000 mm / min
- Rapid traverse speed 5000 mm / min
- Feed force X-Y-Z axis 40% ED 15000 N
- Range
 - Longitudinal X-axis 5850 mm
 - vertical Y-axis 630 mm
 - cross traverse Z-axis 630 mm
- Tool Table - 2 User Version
 - Clamping Surface (X/Y) 2640x 630 mm (l+r)
 - Table max Load each 1000. KG (500kg Table weight)
- 60 tools / tool holder IS50
- RPM 20 - 5000 U / min

A best seller. That require a high efficiency and extreme manufacturing quality, the vertical range of the BA class is almost unbeatable. The machine principle: single spindle with two clamping units together and a 4th CNC axis.

The machines of the vertical line of SW have become a byword for quality and process reliability.



Technical Data:

Technical Data:

Control: SINUMERIK 840C
Spindle Speed: 5.000 rpm
Tool Holder: SK50
Tool Capacity: 60 x

Travels:

X-Axis: 5.850 mm
Y-Axis: 630mm
Z-Axis: 630 mm

Dimensions and Weight:

Height: 4.100 mm
Width: 5.000 mm
Length: 11.400 mm
Weight: 33.000 kg

Buyer Information:

Condition: Very good condition
Availability: Sold
Sold as:
EXW (Ex Works - Incoterm)
VAT: 19 %
Location: Germany



Images:

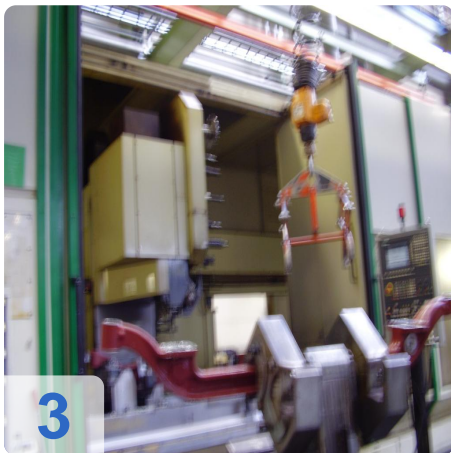



As

e

ssets





As

e

ssets

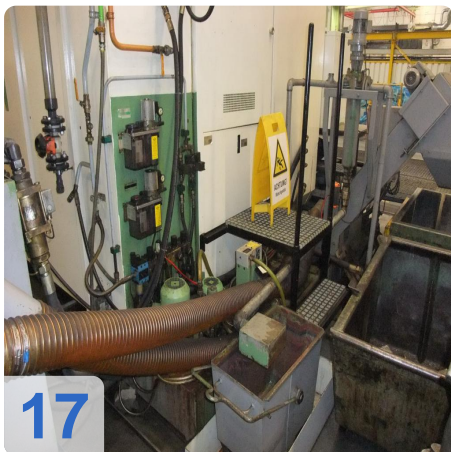



As

e

ssets





As

e

ssets



24



25



26

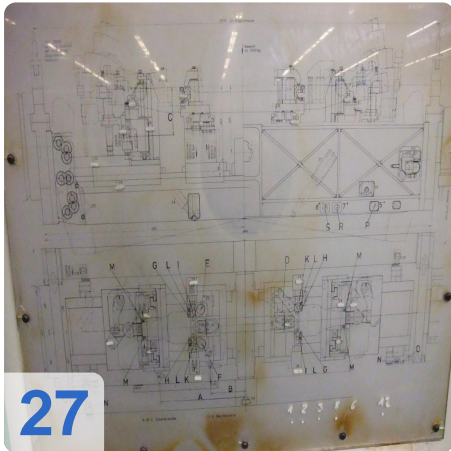

27



28

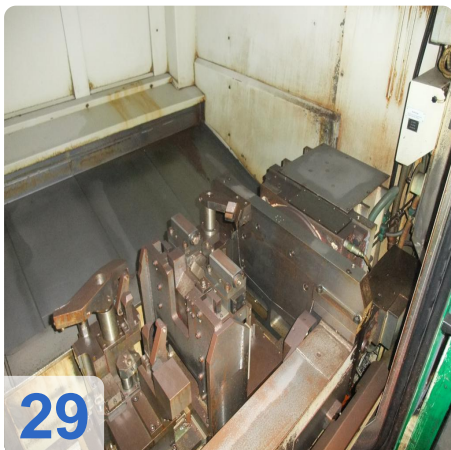

29



As

e

ssets

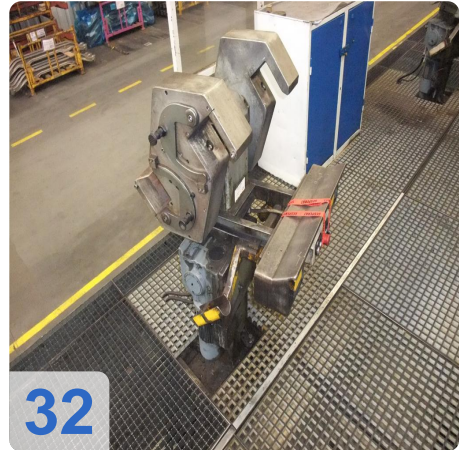



As

e

assets

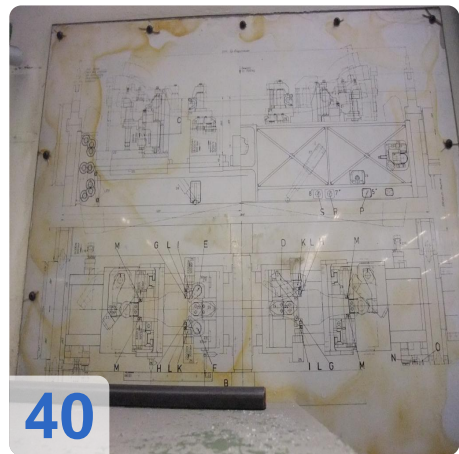

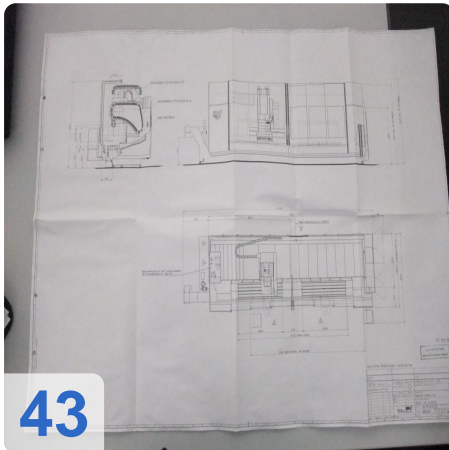



Asset-Trade

Assessment & Sale of Used Assets



Asset-Trade

**Assessment and Sale of Used Assets world
wide**

Am Sonnenhof 16

47800 Krefeld

Germany

Tel.: +49 2151 32500 33