

Technical data

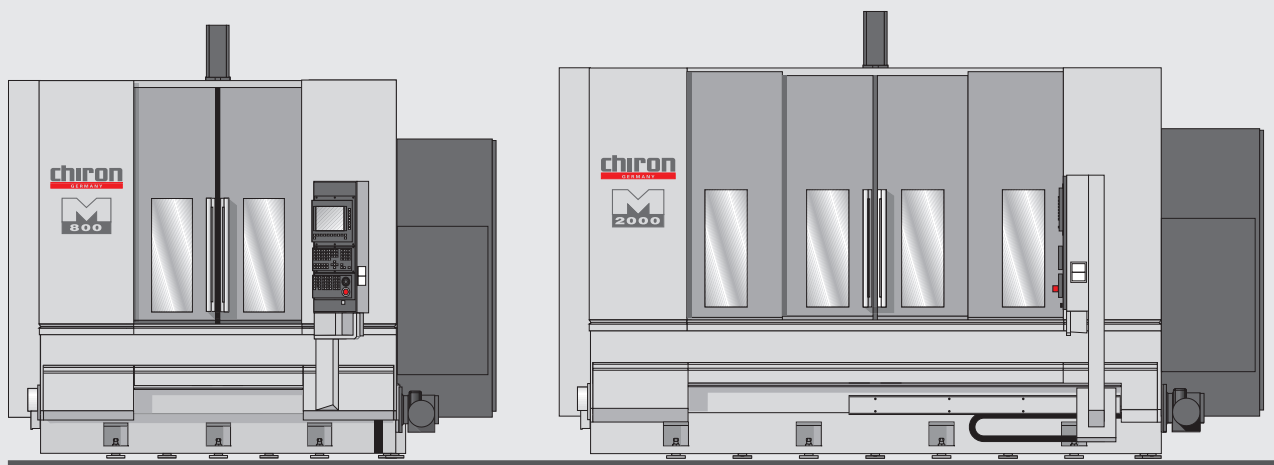

Series MILL

Universal precision machining as well for
combined milling and turning machining

Standard machines

Technical Data	MILL 800	MILL 1250	MILL 2000	MILL 3000	MILL 4500	MILL 6000	MILL 8000
Drilling capacity in st 60 with inserted drill	Ø 42 mm	Ø 42 mm	Ø 42 mm	Ø 42 mm	Ø 42 mm	Ø 42 mm	Ø 42 mm
Tapping	M 30	M 30	M 30	M 30	M 30	M 30	M 30
Milling capacity in st 60	600 cm ³ /min	600 cm ³ /min	600 cm ³ /min	600 cm ³ /min	600 cm ³ /min	600 cm ³ /min	600 cm ³ /min
Tool storage capacity	24	24	24	24	24	24	24
Tool taper ISO 7388	ISO/CAT 40	ISO/CAT 40	ISO/CAT 40	ISO/CAT 40	ISO/CAT 40	ISO/CAT 40	ISO/CAT 40
Max. tool diameter	75 mm	75 mm	75 mm	75 mm	75 mm	75 mm	75 mm
If adjacent places are free	160 mm	160 mm	160 mm	160 mm	160 mm	160 mm	160 mm
Max. tool length	320 mm	320 mm	320 mm	320 mm	320 mm	320 mm	320 mm
Max. tool weight	8 kg	8 kg	8 kg	8 kg	8 kg	8 kg	8 kg
Tool change time approx.	1.5 s	1.5 s	1.5 s	1.5 s	1.5 s	1.5 s	1.5 s
Chip-to-chip-time approx.	4.2 s	4.2 s	4.2 s	4.2 s	4.2 s	4.2 s	4.2 s
Infinitely variable speed range up to	9,000 rpm	9,000 rpm	9,000 rpm	9,000 rpm	9,000 rpm	9,000 rpm	9,000 rpm
Spindle drive (Siemens / Fanuc)	22 kW	22 kW	22 kW	22 kW	22 kW	22 kW	22 kW
Max. torque	140 Nm	140 Nm	140 Nm	140 Nm	140 Nm	140 Nm	140 Nm
Diameter front spindle bearing	70 mm	70 mm	70 mm	70 mm	70 mm	70 mm	70 mm
Tool clamping	6,500 N	6,500 N	6,500 N	6,500 N	6,500 N	6,500 N	6,500 N
Distance spindle to column	220 - 720 mm	220 - 1,060 mm	220 - 720 mm	220 - 850 mm	220 - 850 mm	220 - 850 mm	220 - 850 mm
Distance spindle nose to table surface	90 - 640 mm	90 - 640 mm	90 - 640 mm	90 - 640 mm	90 - 640 mm	90 - 640 mm	90 - 640 mm
Travel X-axis	800 mm	1,250 mm	2,000 mm	3,000 mm	4,500 mm	6,000 mm	8,000 mm
Shuttle operation X-axis max.	–	–	2 x 750 mm	2 x 1,250 mm	2 x 2,000 mm	2 x 2,750 mm	2 x 3,750 mm
Travel Y-axis (+ 80 mm)	500 mm	840 mm	500 mm	630 mm	630 mm	630 mm	630 mm
Travel Z-axis	550 mm	550 mm	550 mm	550 mm	550 mm	550 mm	550 mm
Feed force X- / Y-axis	5,000N	5,000N	5,000N	5,000N	5,000N	5,000N	5,000N
Feed force Z-axis	10,000N	10,000N	10,000N	10,000N	10,000N	10,000N	10,000N
Rapid feed rate X- / Y- / Z-axis	40 m/min	40 m/min	40 m/min	40 m/min	40 m/min	40 m/min	40 m/min
Fixed table version							
Fixed table length	1,400 mm	1,850 mm	2,600 mm	3,600 mm	5,100 mm	6,600 mm	8,600 mm
Fixed table width	550 mm	920 mm	550 mm	710 mm	710 mm	710 mm	710 mm
T-Slots	2 x 18 H 12	4 x 18 H 12	2 x 18 H 12	4 x 18 H 12	4 x 18 H 12	4 x 18 H 12	4 x 18 H 12
Reference slot	18 H 8	18 H 8	18 H 8	18 H 8	18 H 8	18 H 8	18 H 8
Five axis version							
NC-tilting rotary table	± 110°	± 120°	–	–	–	–	–
Face plate diameter	280 mm	630 mm	–	–	–	–	–
Dowel and bolt hole pattern	M 16 x Ø 15H7 x 50 mm	M 16 x Ø 15H7 x 50 mm	–	–	–	–	–
Max. transport load	320 kg	1,000 kg	–	–	–	–	–
Speed 4th/5th axis	30/100 (250) rpm	25/*37,5 rpm	–	–	–	–	–
Direkt path measuring system on 4th and 5th axis	+/- 6"	+/- 6"	–	–	–	–	–
Media connectors at the adapter face plate	6	6	–	–	–	–	,
Chip conveyor, ejection height	1,050 mm	1,050 mm	1,050 mm	1,050 mm	1,050 mm	1,050 mm	1,050 mm
Coolant device, container capacity	900 l	900 l	900 l	900 l	1,400 l	1,400 l	1,400 l
Total connection power approx.	40 kVA	40 kVA	40 kVA	40 kVA	60 kVA	60 kVA	60 kVA
Machine weight approx.	7.0 t	8.5 t	9.5 t	13.5 t	18.5 t	23.5 t	28.5 t
Air connection	6 bar	6 bar	6 bar	6 bar	6 bar	6 bar	6 bar

Options	MILL 800	MILL 1250	MILL 2000	MILL 3000	MILL 4500	MILL 6000	MILL 8000
High Speed Version							
Infinitely variable speed range up to	12,000 rpm	12,000 rpm	12,000 rpm	12,000 rpm	12,000 rpm	12,000 rpm	12,000 rpm
Chip-to-chip-time approx.	3.2 s	3.2 s	3.2 s	3.2 s	3.2 s	3.2 s	3.2 s
Rapid feed rate X / Y- / Z-axis	60 m/min	60 m/min	60 m/min	60 m/min	60 m/min	60 m/min	60 m/min

High Speed Plus Version							
Infinitely variable speed range up to	20,000 rpm	20,000 rpm	20,000 rpm	20,000 rpm	20,000 rpm	20,000 rpm	20,000 rpm
Chip-to-chip-time from	2.9 s	2.9 s	2.9 s	2.9 s	2.9 s	2.9 s	2.9 s
Rapid feed rate X / Y- / Z-axis	60 m/min	60 m/min	60 m/min	60 m/min	60 m/min	60 m/min	60 m/min

More powerful spindle drive							
Infinitely variable speed range up to	12,000 rpm	12,000 rpm	12,000 rpm	12,000 rpm	12,000 rpm	12,000 rpm	12,000 rpm
Spindle drive Siemens	42.7 kW	42.7 kW	42.7 kW	42.7 kW	42.7 kW	42.7 kW	42.7 kW
Max. torque Siemens	180 Nm	180 Nm	180 Nm	180 Nm	180 Nm	180 Nm	180 Nm
Drilling capacity in St 60 with inserted drill	45 mm	45 mm	45 mm	45 mm	45 mm	45 mm	45 mm
Tapping	M 33	M 33	M 33	M 33	M 33	M 33	M 33
Milling capacity in St 60	700 cm ³ /min	700 cm ³ /min	700 cm ³ /min	700 cm ³ /min	700 cm ³ /min	700 cm ³ /min	700 cm ³ /min

More Options							
Tool storage capacity	40 / 60 / 92 / 163	40 / 60 / 92 / 163	40 / 60 / 92 / 163	40 / 60 / 92 / 1635	40 / 60 / 92 / 163	40 / 60 / 92 / 163	40 / 60 / 92 / 163
Travel Y-axis	630	–	630/840	840	840	840	840
Tool taper HSK-A 63	•	•	•	•	•	•	•
Tool length 370 mm (HSK-A 63)	•	•	•	•	•	•	•
NC rotary table	•	•	•	•	•	•	•
NC rotary table with basic fixture	•	•	•	•	•	•	•
2-axis NC rotary table	•	•	•	•	•	•	•
NC rotary table integrated in fixed table	•	•	•	•	•	•	•
Through the spindle coolant up to 70 bar	•	•	•	•	•	•	•
Chip conveyor with full flow cleaning	•	•	•	•	•	•	•
Probe	•	•	•	•	•	•	•
Direct path measuring system	•	•	•	•	•	•	•
Stationary 3-D-probe system	•	•	•	•	•	•	•
Centre guard with mechanically operated opening	–	–	•	•	•	•	•
Tool breakage monitoring/Tool life management	•	•	•	•	•	•	•
Probes for workpiece and tool measurement	•	•	•	•	•	•	•
Signal lamp	•	•	•	•	•	•	•
Handwheel	•	•	•	•	•	•	•
CHIRON Laser Control	•	•	•	•	•	•	•
Control: Siemens, Fanuc, Heidenhain	•	•	•	•	•	•	•
Central lubrication	•	•	•	•	•	•	•
Automatic doors	•	•	•	•	•	•	•

Machines with NC swivel head

Technical Data	MILL 800	MILL 1250	MILL 2000	MILL 3000	MILL 4500	MILL 6000	MILL 8000
Drilling capacity in st 60 with inserted drill	42 mm	42 mm	42 mm	42 mm	42 mm	42 mm	42 mm
Tapping	M 30	M 30	M 30	M 30	M 30	M 30	M 30
Milling capacity in St 60	600 cm ³ /min	600 cm ³ /min	600 cm ³ /min	600 cm ³ /min	600 cm ³ /min	600 cm ³ /min	600 cm ³ /min
Tool storage capacity	24	24	24	24	24	24	24
Tool taper DIN 69893	HSK-A 63	HSK-A 63	HSK-A 63	HSK-A 63	HSK-A 63	HSK-A 63	HSK-A 63
Max. tool diameter	75 mm	75 mm	75 mm	75 mm	75 mm	75 mm	75 mm
If adjacent places are free	160 mm	160 mm	160 mm	160 mm	160 mm	160 mm	160 mm
Max. tool length	320 mm	320 mm	320 mm	320 mm	320 mm	320 mm	320 mm
Max. tool weight	8 kg	8 kg	8 kg	8 kg	8 kg	8 kg	8 kg
Tool change time approx.	1.5 s	1.5 s	1.5 s	1.5 s	1.5 s	1.5 s	1.5 s
Chip-to-chip-time approx.	3.5 s	3.5 s	3.5 s	3.5 s	3.5 s	3.5 s	3.5 s
Infinitely variable speed range up to	12,000 rpm	12,000 rpm	12,000 rpm	12,000 rpm	12,000 rpm	12,000 rpm	12,000 rpm
Spindle drive (Siemens / Fanuc)	34 kW	34 kW	34 kW	34 kW	34 kW	34 kW	34 kW
Max. torque	140 Nm	140 Nm	140 Nm	140 Nm	140 Nm	140 Nm	140 Nm
Diameter front spindle bearing	70 mm	70 mm	70 mm	70 mm	70 mm	70 mm	70 mm
Tool clamping	18,000 N	18,000 N	18,000 N	18,000 N	18,000 N	18,000 N	18,000 N
Distance spindle to column	240 - 720 mm	240 - 1,060 mm	240 - 720 mm	240 - 850 mm	240 - 850 mm	240 - 850 mm	240 - 850 mm
Distance spindle nose to table surface, vert.	90 - 720 mm	90 - 720 mm	90 - 720 mm	90 - 720 mm	90 - 720 mm	90 - 720 mm	90 - 720 mm
Distance spindle nose to table surface, horiz.	190 - 905 mm	190 - 905 mm	190 - 905 mm	190 - 905 mm	190 - 905 mm	190 - 905 mm	190 - 905 mm
Swivel head with gear drive							
NC positioning axis	±100°	±100°	±100°	±100°	±100°	±100°	±100°
Resolution	0,001°	0,001°	0,001°	0,001°	0,001°	0,001°	0,001°
Repeatability	±10"	±10"	±10"	±10"	±10"	±10"	±10"
Drive torque	280 Nm	280 Nm	280 Nm	280 Nm	280 Nm	280 Nm	280 Nm
Holding moment clamping	1,400 Nm	1,400 Nm	1,400 Nm	1,400 Nm	1,400 Nm	1,400 Nm	1,400 Nm
Swivel head with torque drive							
NC positioning axis	±110°	±110°	±110°	±110°	±110°	±110°	±110°
Resolution	0,001°	0,001°	0,001°	0,001°	0,001°	0,001°	0,001°
Repeatability (direct path measuring system)	±5"	±5"	±5"	±5"	±5"	±5"	±5"
Drive torque	240 Nm	240 Nm	240 Nm	240 Nm	240 Nm	240 Nm	240 Nm
Holding moment clamping	2,350 Nm	2,350 Nm	2,350 Nm	2,350 Nm	2,350 Nm	2,350 Nm	2,350 Nm
Travel X-axis	800 mm	1,250 mm	2,000 mm	3,000 mm	4,500 mm	6,000 mm	8,000 mm
Shuttle operation X-axis max.	-	-	2 x 765 mm	2 x 1,265 mm	2 x 2,015 mm	2 x 2,765 mm	2 x 3,765 mm
Travel Y-axis	480 mm	820 mm	480 mm	610 mm	610 mm	610 mm	610 mm
Feed force X- / Y-axis	5,000N	5,000N	5,000N	5,000N	5,000N	5,000N	5,000N
Travel Z-axis vertical/horizontal	630/715 mm	630/715 mm	630/715 mm	630/715 mm	630/715 mm	630/715 mm	630/715 mm
Feed force Z-axis	10,000N	10,000N	10,000N	10,000N	10,000N	10,000N	10,000N
Rapid feed rate X- / Y- / Z-axis	40 m/min	40 m/min	40 m/min	40 m/min	40 m/min	40 m/min	40 m/min
Fixed table length	1,400 mm	1,850 mm	2,600 mm	3,600 mm	5,100 mm	6,600 mm	8,600 mm
Fixed table width	550 mm	920 mm	550 mm	710 mm	710 mm	710 mm	710 mm
T-Slots	2 x 18 H12	2 x 18 H12	2 x 18 H12	2 x 18 H12	2 x 18 H12	2 x 18 H12	2 x 18 H12
Reference slot	18 H8	18 H8	18 H8	18 H8	18 H8	18 H8	18 H8
Chip conveyor discharge height	1,050 mm	1,050 mm	1,050 mm	1,050 mm	1,050 mm	1,050 mm	1,050 mm
Coolant device, container capacity	900 l	900 l	900 l	900 l	1,400 l	1,400 l	1,400 l
Total connection power approx.	40 kVA	40 kVA	40 kVA	40 kVA	60 kVA	60 kVA	60 kVA
Machine weight approx.	7.0 t	8.5 t	9.5 t	13.5 t	18.5 t	23.5 t	23.5 t
Air connection	6 bar	6 bar	6 bar	6 bar	6 bar	6 bar	6 bar

Options	MILL 800	MILL 1250	MILL 2000	MILL 3000	MILL 4500	MILL 6000	MILL 8000
Technology package "Milling from bars"							
NC rotary table, max. speed	45 rpm	–	–	–	–	–	–
Autom. collect clamping for collet chucks up to	Ø 100 mm	–	–	–	–	–	–
NC slide for bar feed, max. stroke	1,100 mm	–	–	–	–	–	–
NC turning device with clamping stock for machining	6 th side	–	–	–	–	–	–
Technology package "Turning from bars"							
Turning spindle with collet chuck take-up	14.1 kW	–	14.1 kW	–	–	–	–
Bar passage, max.	Ø 65 / 100 mm	–	Ø 65 / 100 mm	–	–	–	–
Infinitely variable speed range up to	4,500/3,000 rpm	–	4,500/3,000 rpm	–	–	–	–
Max. torque	90 Nm	–	90 Nm	–	–	–	–
NC slide for bar feed, max. stroke	1,100 mm	–	1,550 mm	–	–	–	–
NC turning device with clamping stock for machining	6 th side	–	–	–	–	–	–
Opposed spindle for machining	–	–	6 th side	–	–	–	–
High Speed Plus Version							
Infinitely variable speed range up to	20,000 rpm	20,000 rpm	20,000 rpm	20,000 rpm	20,000 rpm	20,000 rpm	20,000 rpm
Chip-to-chip-time from	2.9 s	2.9 s	2.9 s	2.9 s	2.9 s	2.9 s	2.9 s
Rapid feed rate X- / Y- / Z-axis	60 m/min	60 m/min	60 m/min	60 m/min	60 m/min	60 m/min	60 m/min
More Options							
Tool storage capacity	40 / 60 / 92 / 163	40 / 60 / 92 / 163	40 / 60 / 92 / 163	40 / 60 / 92 / 163	40 / 60 / 92 / 163	40 / 60 / 92 / 163	40 / 60 / 92 / 163
Tool length 370 mm	•	•	•	•	•	•	•
Travel Y-axis	610	–	610/820	820	820	820	820
NC rotary table	•	•	•	•	•	•	•
NC rotary table integrated in fixed table	•	•	•	•	•	•	•
NC rotary table with basic fixture	•	•	•	•	•	•	•
Through the spindle coolant up to 70 bar	•	•	•	•	•	•	•
Chip conveyor with full flow cleaning	•	•	•	•	•	•	•
CHIRON Laser Control	•	•	•	•	•	•	•
Probe	•	•	•	•	•	•	•
Direct path measuring system	•	•	•	•	•	•	•
Stationary 3-D-probe system	•	•	•	•	•	•	•
Centre guard with mechanically operated opening	–	–	•	•	•	•	•
Probes for workpiece and tool measurement	•	•	•	•	•	•	•
Tool breakage monitoring/Tool life management	•	•	•	•	•	•	•
Signal lamp	•	•	•	•	•	•	•
Handwheel	•	•	•	•	•	•	•
Control: Siemens, Fanuc, Heidenhain	•	•	•	•	•	•	•
Suctioning unit	•	–	•	–	–	–	–
NC linear unit with NC turning device	•	–	•	–	–	–	–
Central lubrication	•	•	•	•	•	•	•
Automatic doors	•	•	•	•	•	•	•

Dimensions

MILL Series	MILL 800	MILL 1250	MILL 2000	MILL 3000	MILL 4500	MILL 6000	MILL 8000
a Total length	5,354 mm	6,033 mm	6,654 mm	8,788 mm	10,785 mm	12,835 mm	15,771 mm
b1 Cabin width min., (24 tools, Y = 500)	2,735 mm	3,415 mm	2,735 mm	2,995 mm	2,995 mm	2,995 mm	2,995 mm
b2 Cabin width max., (60 tools, Y = 840)	4,435 mm	4,855 mm	4,855 mm	4,855 mm	4,855 mm	4,855 mm	4,855 mm
b3 Width background tool magazine (92 or 163 tools)	800 mm	800 mm	800 mm	800 mm	800 mm	800 mm	800 mm
c Control panel width	330 mm	330 mm	467 mm	467 mm	467 mm	467 mm	467 mm
d Total height max.	2,990 mm	3,110 mm	3,110 mm	3,170 mm	3,170 mm	3,170 mm	3,170 mm
e Cabin height max.	2,545 mm	2,545 mm	2,545 mm	2,545 mm	2,545 mm	2,545 mm	2,545 mm
f Control panel height max.	1,875 mm	1,875 mm	1,875 mm	1,875 mm	1,875 mm	1,875 mm	1,875 mm
g Height of fixed table	905 mm	945 mm	905 mm	945 mm	945 mm	945 mm	945 mm
h Length of fixed table	1,400 mm	1,850 mm	2,600 mm	3,600 mm	5,100 mm	6,600 mm	8,600 mm
j Width of fixed table	550/710 mm	920 mm	550/710/920 mm	710/920 mm	710/920 mm	710/920 mm	710/920 mm
k Distance spindle nose to table surface	90 mm	90 mm	90 mm	90 mm	90 mm	90 mm	90 mm
l Height of discharge funnel	1,050 mm	1,050 mm	1,050 mm	1,050 mm	1,050 mm	1,050 mm	1,050 mm
x Travel X-axis	800 mm	1,250 mm	2,000 mm	3,000 mm	4,500 mm	6,000 mm	8,000 mm
y Travel Y-axis	500/630 mm	840 mm	500/630/840 mm	630/840 mm	630/840 mm	630/840 mm	630/840 mm
z Travel Z-axis	550 mm	550 mm	550 mm	550 mm	550 mm	550 mm	550 mm

Fixe Axis Version

g1 Height of fixed table	795 mm	825 mm
h1 Bridge size	950 mm	1,390 mm
j1 Faceplate diameter	280 mm	630 mm

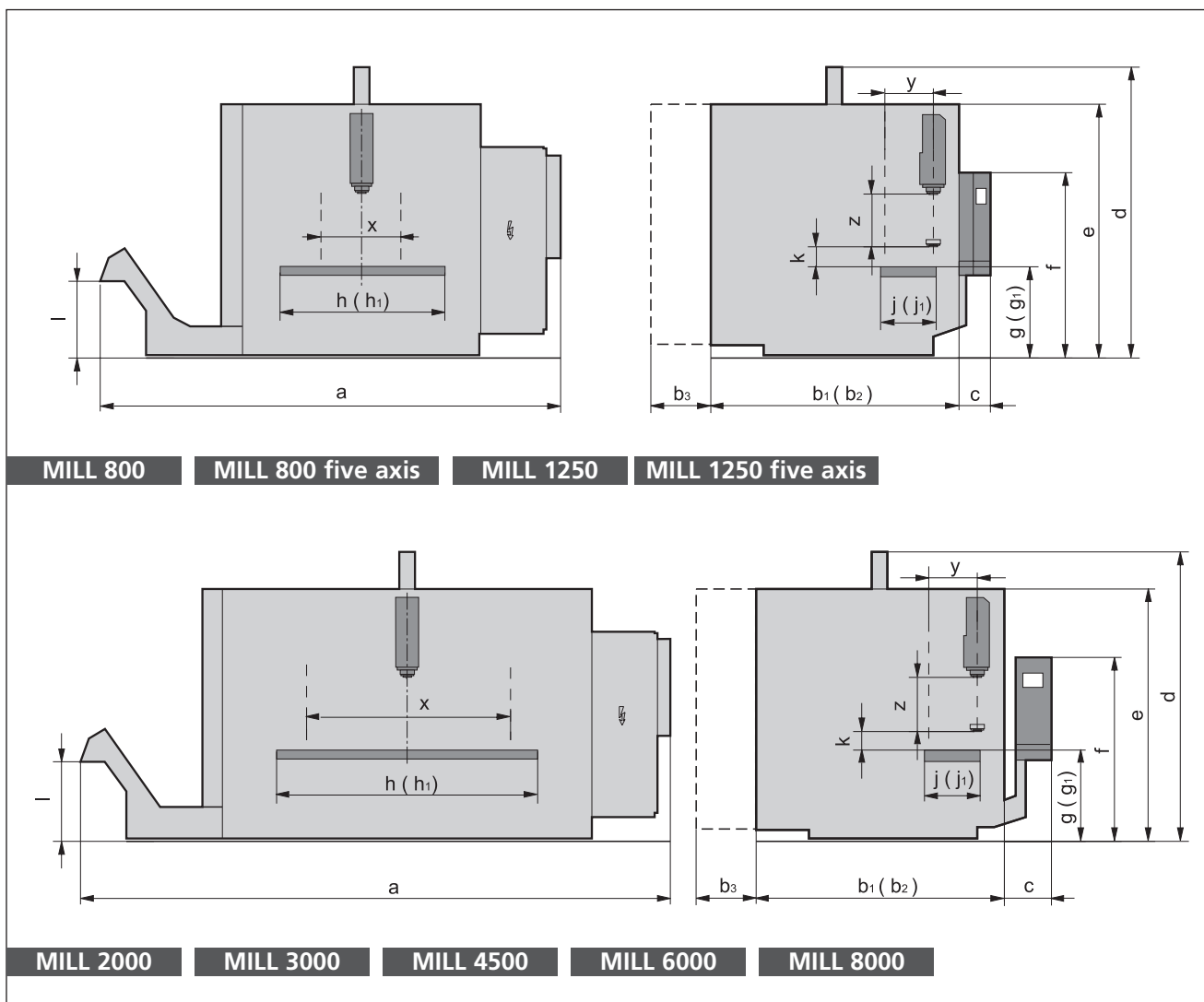

Working Area NC Swivel Head	MILL 800	MILL 1250	MILL 2000	MILL 3000	MILL 4500	MILL 6000	MILL 8000
L ₁ Travel X-axis	800 mm	1,250 mm	2,000 mm	3,000 mm	4,500 mm	6,000 mm	8,000 mm
L ₂ Travel Z-axis, vertical	630 mm	630 mm	630 mm	630 mm	630 mm	630 mm	630 mm
L ₃ Distance spindle nose to swivel head	185 mm	185 mm	185 mm	185 mm	185 mm	185 mm	185 mm
L ₄ Distance spindle nose to table surface	90 mm	90 mm	90 mm	90 mm	90 mm	90 mm	90 mm
L ₅ Travel Z-axis, horizontal	715 mm	715 mm	715 mm	715 mm	715 mm	715 mm	715 mm
L ₆ Distance spindle axis to table surface	190 mm	190 mm	190 mm <td 190 mm	190 mm	190 mm	190 mm	
L ₇ Travel Y-axis	480/610 mm	820 mm	480/610/820 mm	610/820 mm	610/820 mm	610/820 mm	610/820 mm
L ₈ Distance reference point to table centre	230/295 mm	400 mm	230/295/400 mm	295/400 mm	295/400 mm	295/400 mm	295/400 mm
L ₉ Distance table centre to travel	250/315 mm	420 mm	250/315/420 mm	315/420 mm	315/420 mm	315/420 mm	315/420 mm

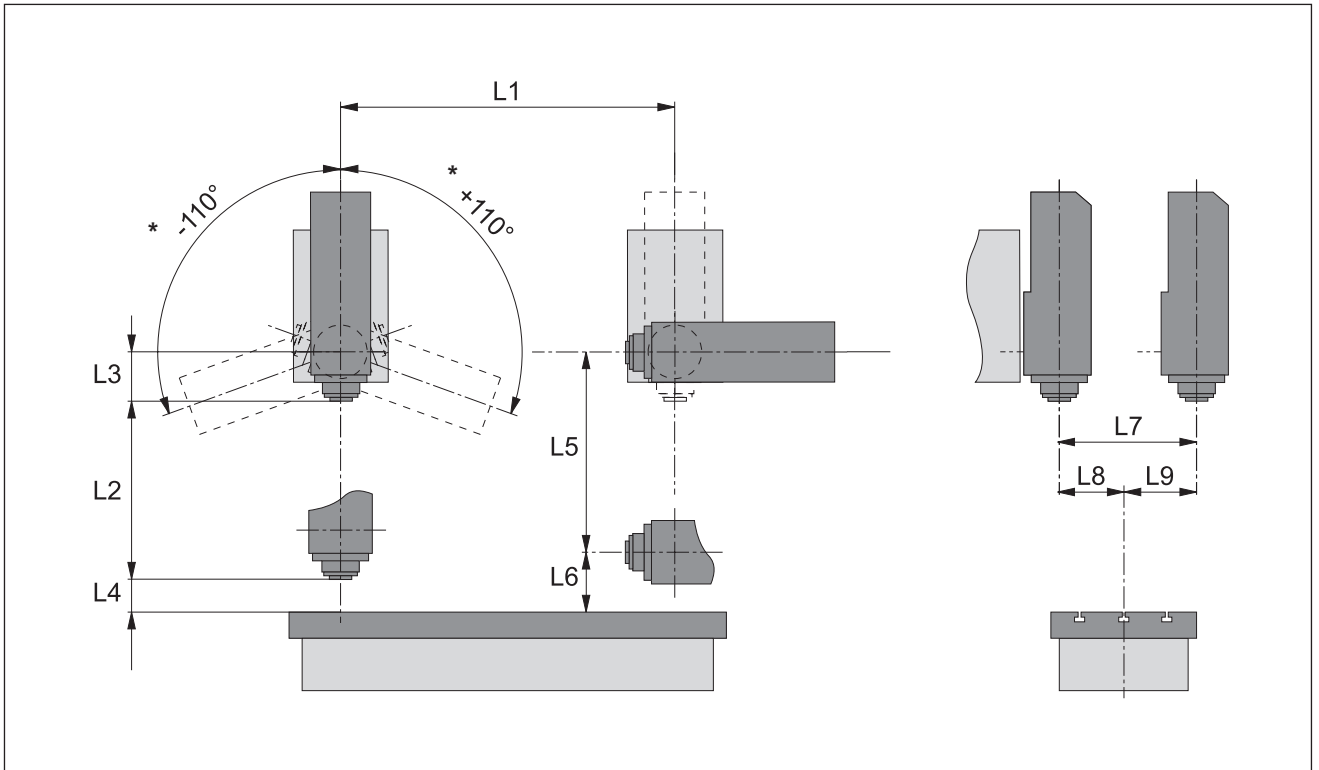

* Swivel head with gear drive: $\pm 100^\circ$
 Swivel head with torque drive: $\pm 110^\circ$

Series MILL – Options

High speed version
Technology package “Milling from bars”
Technology package “Turning from bars”
Travel Y-axis up to 840 mm
Tool storage capacity 24 / 40 / 60 / 92 / 163
Tool taper HSK-A 63
Tool length up to 370 mm
Through the spindle coolant up to 70 bar
Chip conveyor with full flow cleaning
Coolant treatment
NC-swivel head
NC rotary table
NC rotary table with basic fixture
NC rotary table integrated in fixed table
2-axis NC rotary table
Probes for workpiece and tool measurement
CHIRON Laser Control
Tool breakage monitoring / Tool life management
Stationary 3-D-probe system
Probe
Direct path measuring system
Suctioning unit
Machining with minimal lubrication
Centre guard with mechanically operated opening
Automatic doors
Handwheel
Signal lamp
Multi-spindle head adaptor
Control: Siemens, Fanuc, Heidenhain

Basic series

08 MAGNUM Series

Fast, compact milling centers for high precision and diverse applications

12 Series

Fast, compact single and multi-spindle precision machining centers

15 Series

Fast, powerful, single and twin-spindle precision milling centers for profitable series production

18 Series

Powerful, single and twin-spindle machining centers for high-speed machining and heavy cutting

MILL Series

Universal precision machining centers as well for combined milling and turning machining

BIG MILL Series

High-precision machining centers for heavy cutting and large workpieces

Flexible production systems

FLEXCELL UNO / DUO

Robot-automated 6-side complete machining

MPC

Pallet automation

CHIRON subsidiaries

CHIRON Technologies de Production SAS

14 Chemin de la Litte
92390 Villeneuve-la-Garenne, France
Tel. +33 1 47 98-5950, Fax -5431
info@chiron-technologies.fr
www.chiron-technologies.fr

CHIRON Italia S.p.A.

Via Ambrosoli 4/C
20090 Rodano Millepini – (MI), Italy
Tel. +39 02 953-21102, Fax -28620
info@chironitalia.it
www.chironitalia.it

CHIRON Istanbul Makine Ticaret ve Servis Limited Şirketi

Topçular Mah.
Kışla Cad. Cicoz Yolu No: 1
Kuşçu Plaza D: 11
34055 Eyüp/Istanbul, Turkey
Tel. +90 212 612-12 11, Fax -4828
info@chiron-turkey.com

CHIRON-WERKE

Asia Pacific Pty. Ltd.
18 North Drive, Virginia Park
236-262 East Boundary Road
East Bentleigh, Vic 3165, Australia
Tel. +61 395-750 000, Fax -637 944
info@chiron.com.au
www.chiron.com.au

CHIRON Machine Tool (Beijing) Ltd. China

Room 1203, Tower 1,
China Central Plaza Office Building
No. 81, Jianguo Road, Chaoyang District,
Beijing 100025, China
Tel. +86 10-6598 9811, Fax -9812
info@chiron-china.com
www.chiron-china.com

CHIRON-America INC.

10950 Withers Cove Park Drive
Charlotte, NC 28278, United States of America
Tel. +01 704 587-9526, Fax -0485
info@chironamerica.com
www.chironamerica.com

CHIRON India Machine Tools Private Limited

#33, Naseer Affinity, 1st Floor
Miller Tank Bunk Road, Kaveriappa Layout,
Vasanth Nagar, Bangalore - 560 052, India
Tel. +91 80 4905-6490, Fax -6450
info@chiron-india.com
www.chiron-india.com

CMS-GmbH

Gewerbepark „take-off“ 125
78579 Neuhausen ob Eck, Germany
Tel. +49 7461 940-3700, Fax -3701
cms@chiron.de
www.cms-gebrauchtmaschinen.de

CHIRON-WERKE GmbH & Co. KG

Kreuzstrasse 75
78532 Tuttlingen, Germany
Tel. +49 7461 940-0
Fax +49 7461 940-8000
info@chiron.de